

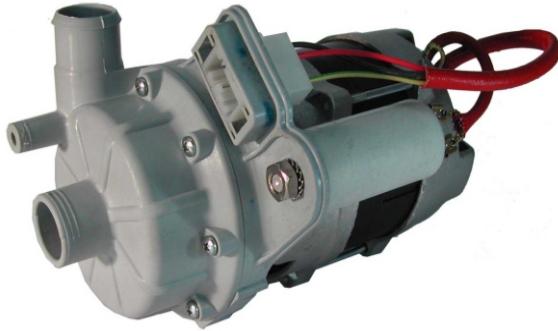

# ZFCi121C kW 0.35 Hm 6.0 max Hp 0.48 L/1' 106 max

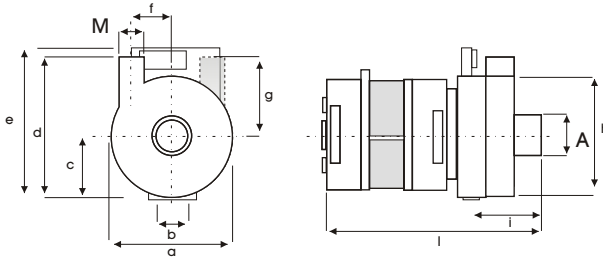

Corpo pompa Pump Body Pumpengehaus	<b>PP 30 GF</b>
Girante Chiusa Closed Impeller Geschl.Laufrad	<b>PPO 20 GF</b>
Albero motore Motor Shaft Motorwelle	<b>AISI 430 F</b>
Tenuta meccanica. Mechanical Seal Gleitringdichtung	<b>GRAFITE/CERAMICA CARBON/CERAMIC KOHLE/KERAMIK</b>



	DX	A1	M1
	L2	28	28

REVISIONE N.03.01/03

mod	a	b	c	d	e	f	g	h	i	l	m	n	o	kg
ZF121	102	24,5	51,2	121	132	27,5	70,1	102	65	196				3,0

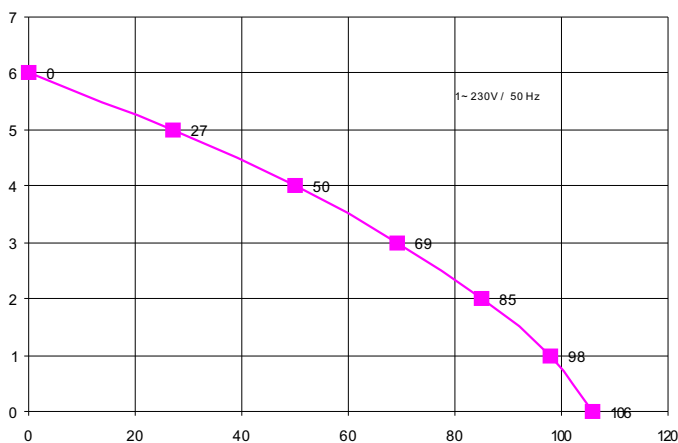

H m	0	1	2	3	4	5	6
L / 1'	106	90	85	69	50	27	0

Ci riserviamo il diritto di apportare modifiche tecniche

We reserve the right of technical modifications

Technische Änderungen vorbehalten

Potenza motore Motor power Motor Leistung	<b>Hp</b>	<b>kW</b>
	<b>0,45</b>	<b>0,33</b>
Tensione/Frequenza Tension/Frequency Spannung/Frequenz	<b>1~V/Hz</b>	
	<b>230/50</b>	
Corrente assorbita Power consumption Stromaufnahme	<b>A</b>	
	<b>1,48</b>	
GPM RPM UPM	<b>2800</b>	
Condensatore Motor Power Motor Leistung	<b>8 µF</b>	
Protezione termica Thermal Overload Überlastschutz	<b>155 °C</b>	
Classe isolamento Insulation class Isolationsklasse	<b>F</b>	
Grado protezione Protection class Schutzklasse	<b>IP 00</b>	
Servizio Duty Betriebsart	<b>S1</b>	<b>CONTINUO CONTINUOUS DAUERBETRIEB</b>