



ELETTROPOMPE CON MOTORE APERTO

ELECTRIC PUMPS WITH OPEN ELECTRIC MOTOR

ELEKTROPUMPEN MIT OFFENEM MOTOR

IP 00

ALTA PORTATA

HOHE FÖRDELEISTUNG

HIGH FLOW

3



ZF 115A

kW 0.16 Hm 7 max
Hp 0.21 L/1' 125 max



Corpo Pompa Pump Body Pumpengehäuse	PP 30 GF
Girante Aperta Open Impeller Offenes Laufrad	SPS G30
Albero Motore Motor Shaft Motorwelle	AISI 430 F
Tenuta Meccanica Mechanical Seal Gleitringdichtung	GRAFITE/CERAMICA CARBON/CERAMIC KOHLE/KERAMIK

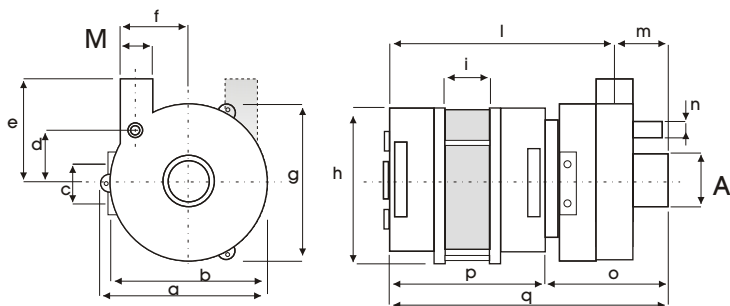

SX	A	M	DX	A	M
	L3: 28	28		L3: 28	28

mod	a	b	c	d	e	f	g	h	i	l	m	n	o	p	q	kg
ZF 115	104	98	24	32,5	67	28	96	102	30	149	37	12	77	109	186	2,8

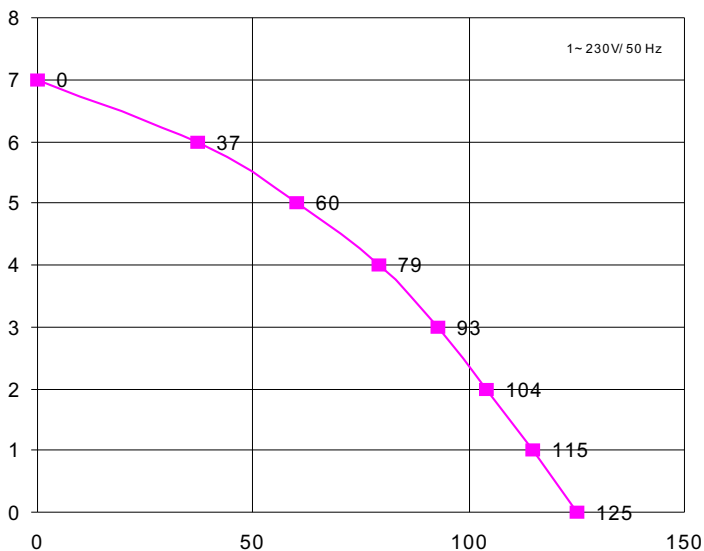

H m	0	1	2	3	4	5	6	7
L / 1'	125	115	104	93	79	60	37	0

Potenza motore Motor power Motor Leistung	Hp kW
	0,21 0,16

Tensione/Frequenza Tension/Frequency Spannung/Frequenz	1-V/Hz
	230/50

Corrente assorbita Power consumption Stromaufnahme	A
	0,9

GPM RPM UPM	2800
-------------------	-------------

Condensatore Capacitor Kondensator	5 µF
--	-------------

Protezione termica Thermal Overload Überlastschutz	155 °C
--	---------------

Classe isolamento Insulation class Isolationsklasse	F
---	----------

Grado protezione Protection class Schutzklasse	IP 00
--	--------------

Servizio Duty Betriebsart	S1	CONTINUO CONTINUOUS DAUERBETRIEB
---------------------------------	-----------	---

REVISIONE N.02.07/04 ATE20 03/09.1

Ci riserviamo il diritto di apportare modifiche tecniche.
We reserve the right of technical modifications.
Technische Änderungen vorbehalten.



ZF 115C

kW 0.16 Hm 7 max
Hp 0.21 L/1' 118 max



Corpo Pompa Pump Body Pumpengehäuse	PP 30 GF
Girante Chiusa Closed Impeller Geschl. Laufrad	PPO 20GF
Albero Motore Motor Shaft Motorwelle	AISI 430 F
Tenuta Meccanica Mechanical Seal Gleitringdichtung	GRAFITE/CERAMICA CARBON/CERAMIC KOHLE/KERAMIK

REVISIONE N.02.07/04 ATE20 03/092

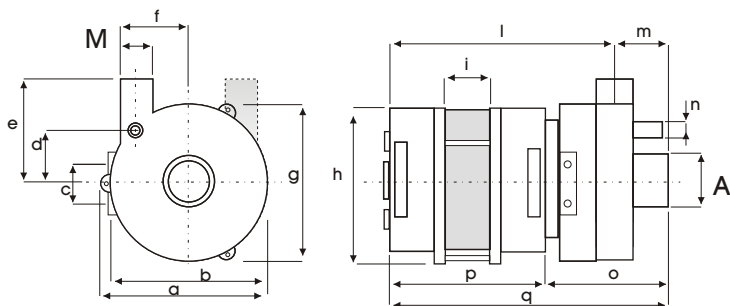

N.B.:
Molto silenziosa !
Very low noise !
Sehr geräuscharm !

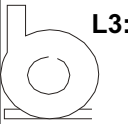
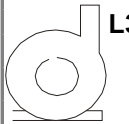
SX	A	M	DX	A	M
 L3:	28	28	 L3:	28	28

mod	a	b	c	d	e	f	g	h	i	l	m	n	o	p	q	kg
ZF 115	104	98	24	32,5	67	28	96	102	30	149	37	12	77	109	186	2,8

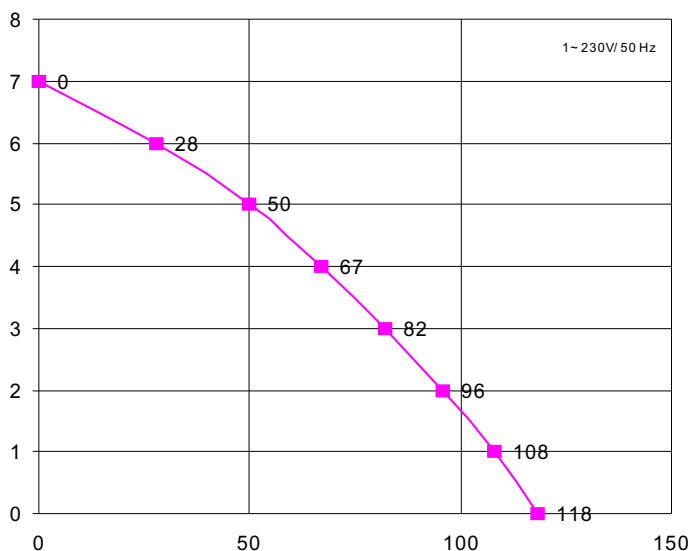

H m	0	1	2	3	4	5	6	7
L / 1'	118	108	96	82	67	50	28	0

Potenza motore Motor power Motor Leistung	Hp kW 0,21 0,16
Tensione/Frequenza Tension/Frequency Spannung/Frequenz	1~V/Hz 230/50
Corrente assorbita Power consumption Stromaufnahme	A 0,9
GPM RPM UPM	2800
Condensatore Capacitor Kondensator	5 µF
Protezione termica Thermal Overload Überlastschutz	155 °C
Classe isolamento Insulation class Isolationsklasse	F
Grado protezione Protection class Schutzklasse	IP 00
Servizio Duty Betriebsart	S1 CONTINUO CONTINUOS DAUERBETRIEB

Ci riserviamo il diritto di apportare modi fiche tecniche.
We reserve the right of technical modifications.
Technische Änderungen vorbehalten.



ZFCi121A

kW 0.33
Hp 0.45

Hm 7.6 max
L/1' 138 max

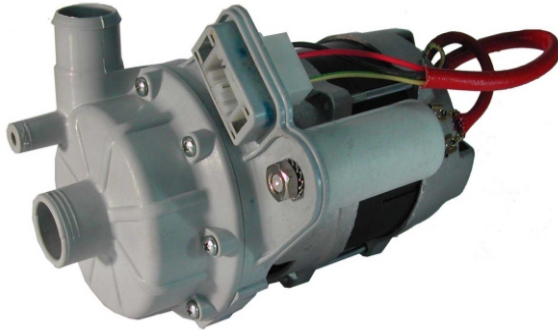

Corpo pompa Pump Body Pumpengehaus	PP 30 GF
Girante Aperta Open Impeller Ø73 Offenes Laufrad	SPS G30
Albero motore Motor Shaft Motorwelle	AISI 430 F
Tenuta meccanica. Mechanical Seal Gleitringdichtung	GRAFITE/CERAMICA CARBON/CERAMIC KOHLE/KERAMIK

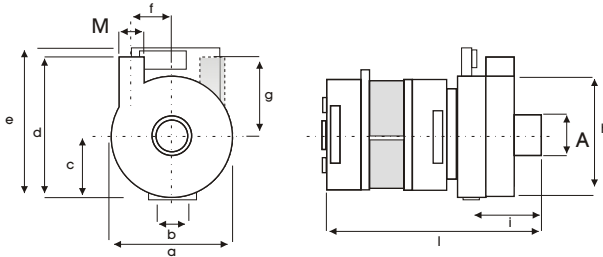

SX	A1	M1	DX	A1	M1	kg	
	L2	28	28		L2	28	28

mod	a	b	c	d	e	f	g	h	i	l	m	n	o	kg
ZF121	102	24,5	51,2	121	132	27,5	70,1	102	65	196				3,0

Potenza motore Motor power Motor Leistung	Hp 0,45 kW 0,33
Tensione/Frequenza Tension/Frequency Spannung/Frequenz	1~V/Hz 230/50
Corrente assorbita Power consumption Stromaufnahme	A 1,48
GPM RPM UPM	2800
Condensatore Motor Power Motor Leistung	8 µF
Protezione termica Thermal Overload Überlastschutz	155 °C
Classe isolamento Insulation class Isolationsklasse	F
Grado protezione Protection class Schutzklasse	IP 00
Servizio Duty Betriebsart	S1 CONTINUO CONTINUOUS DAUERBETRIEB

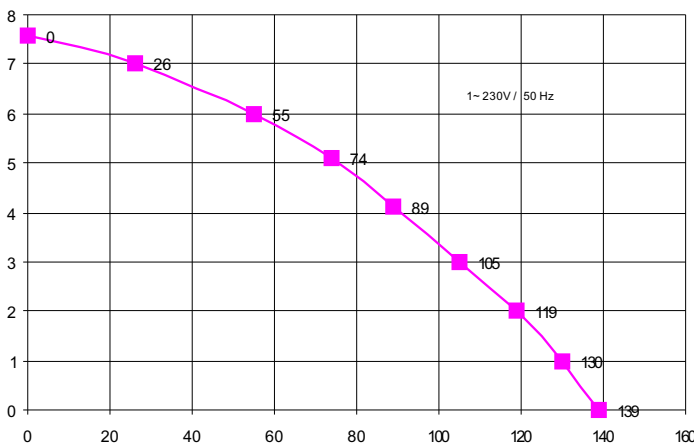

H m	0	1	2	3	4	5	6	7,6
L / 1'	139	130	119	105	89	74	55	0

Ci riserviamo il diritto di apportare modifiche tecniche
We reserve the right of technical modifications
Technische Änderungen vorbehalten

REVISIONE N.03.01/03



ZFCi121B

kW 0.35

Hm 8.1 max

Hp 0.48

L/1' 159 max

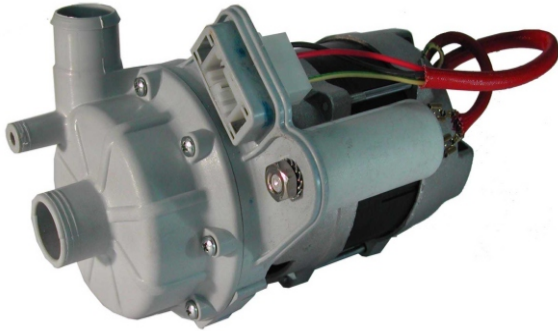

Corpo pompa Pump Body Pumpengehaus	PP 30 GF
Girante Chiusa Closed Impeller Geschl.Laufrad	p.a. SPS G30
Albero motore Motor Shaft Motorwelle	AISI 430 F
Tenuta meccanica. Mechanical Seal Gleitringdichtung	GRAFITE/CERAMICA CARBON/CERAMIC KOHLE/KERAMIK

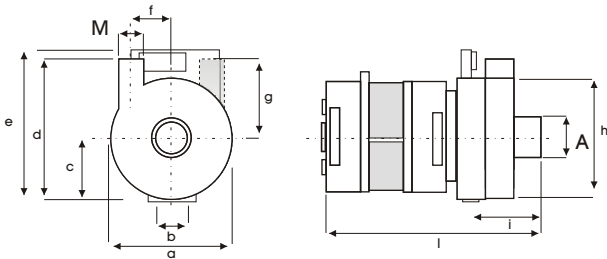

	DX	A1	M1
L2	28	28	

mod	a	b	c	d	e	f	g	h	i	l	m	n	o	kg
ZF121	102	24,5	51,2	121	132	27,5	70,1	102	65	196				3,0

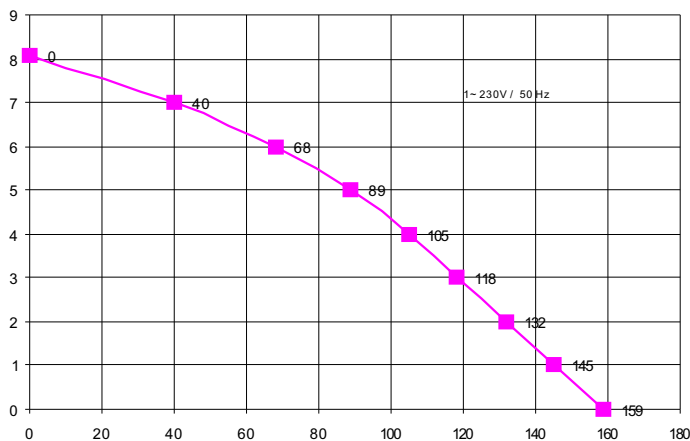

H m	0	1	2	3	4	5	6	7	8,1
L / 1'	159	145	132	118	105	89	68	40	0

Ci riserviamo il diritto di apportare modifiche tecniche

We reserve the right of technical modifications

Technische Änderungen vorbehalten

Potenza motore Motor power Motor Leistung	Hp	kW
	0,45	0,33

Tensione/Frequenza Tension/Frequency Spannung/Frequenz	1~V/Hz
	230/50

Corrente assorbita Power consumption Stromaufnahme	A
	1,48

GPM RPM UPM	2800
-------------------	-------------

Condensatore Motor Power Motor Leistung	8 µF
---	-------------

Protezione termica Thermal Overload Überlastschutz	155 °C
--	---------------

Classe isolamento Insulation class Isolationsklasse	F
---	----------

Grado protezione Protection class Schutzklasse	IP 00
--	--------------

Servizio Duty Betriebsart	S1	CONTINUO CONTINUOUS DAUERBETRIEB
---------------------------------	-----------	--

REVISIONE N.03.01/03



ZFCi121C kW 0.35 Hm 6.0 max Hp 0.48 L/1' 106 max

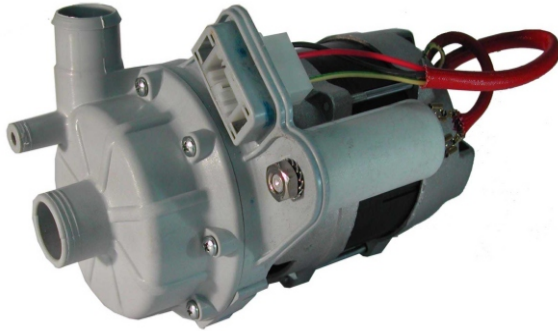

Corpo pompa Pump Body Pumpengehaus	PP 30 GF
Girante Chiusa Closed Impeller Geschl.Lauftrad	PPO 20 GF
Albero motore Motor Shaft Motorwelle	AISI 430 F
Tenuta meccanica. Mechanical Seal Gleitringdichtung	GRAFITE/CERAMICA CARBON/CERAMIC KOHLE/KERAMIK

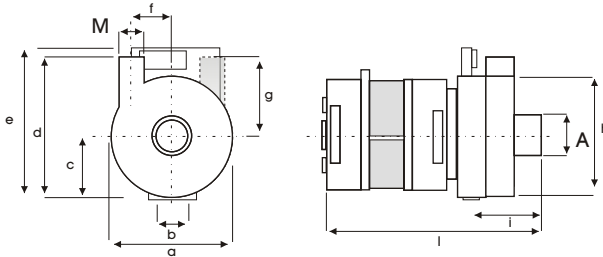

	DX	A1	M1
	L2	28	28

REVISIONE N.03.01/03

mod	a	b	c	d	e	f	g	h	i	l	m	n	o	kg
ZF121	102	24,5	51,2	121	132	27,5	70,1	102	65	196				3,0

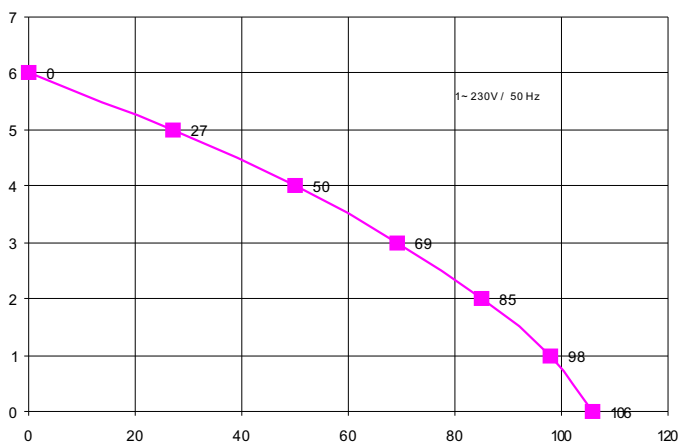

H m	0	1	2	3	4	5	6
L / 1'	106	90	85	69	50	27	0

Ci riserviamo il diritto di apportare modifiche tecniche

We reserve the right of technical modifications

Technische Änderungen vorbehalten

Potenza motore Motor power Motor Leistung	Hp	kW
	0,45	0,33
Tensione/Frequenza Tension/Frequency Spannung/Frequenz	1~V/Hz	
	230/50	
Corrente assorbita Power consumption Stromaufnahme	A	
	1,48	
GPM RPM UPM	2800	
Condensatore Motor Power Motor Leistung	8 µF	
Protezione termica Thermal Overload Überlastschutz	155 °C	
Classe isolamento Insulation class Isolationsklasse	F	
Grado protezione Protection class Schutzklasse	IP 00	
Servizio Duty Betriebsart	S1	CONTINUO CONTINUOUS DAUERBETRIEB



ZFCi 121dx

kW 0.24 Hm 6.5 max
Hp 0.32 L/1' 112 max

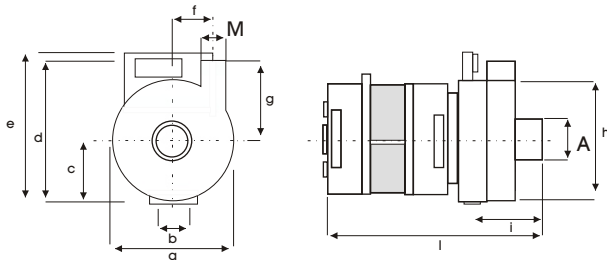

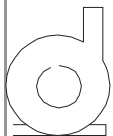
	DX	A1	M1
	L2	28	28

mod	a	b	c	d	e	f	g	h	i	l	m	n	o	kg
ZF121	102	24,5	51,2	121	132	27,5	70,1	102	65	196				3,0

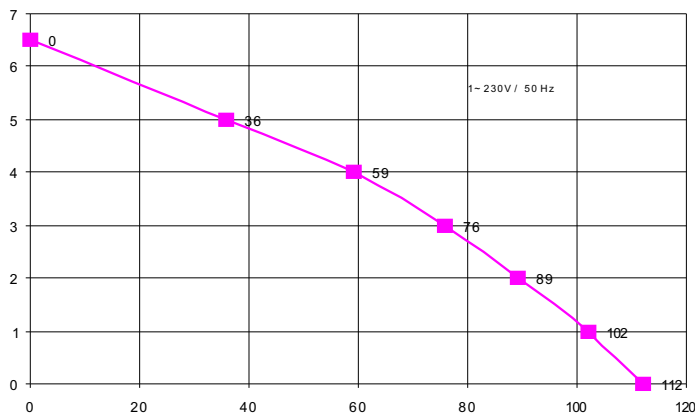

H m	0	1	2	3	4	5	6,5
L / 1'	112	102	89	76	59	36	0

Corpo pompa Pump Body Pumpengehaus	PP 30 GF
Girante Chiusa Closed Impeller Geschl.	PPO 20 GF
Albero motore Motor Shaft Motorwelle	AISI 430 F
Tenuta meccanica. Mechanical Seal Gleitringdichtung	GRAFITE/CERAMICA CARBON/CERAMIC KOHLE/KERAMIK

Potenza motore Motor power Motor Leistung	Hp	kW
	0,31	0,23
Tensione/Frequenza Tension/Frequency Spannung/Frequenz	1~V/Hz 230/50	
Corrente assorbita Power consumption Stromaufnahme	A 1,1	
GPM RPM UPM	2800	
Condensatore Motor Power Motor Leistung	6,3 µF	
Protezione termica Thermal Overload Überlastschutz	155 °C	
Classe isolamento Insulation class Isolationsklasse	F	
Grado protezione Protection class Schutzklasse	IP 00	
Servizio Duty Betriebsart	S1	CONTINUO CONTINUOS DAUERBETRIEB

Ci riserviamo il diritto di apportare modifiche tecniche

We reserve the right of technical modifications

Technische Änderungen vorbehalten



ZF 130A

kW 0.30 Hm 8.0 max
Hp 0.40 L/1'129 max



Corpo Pompa
Pump Body
Pumpengehäuse **PP 30 GF**

Girante Aperta
Open Impeller
Offenes Laufrad **SPS G30**
paØ73

Albero Motore
Motor Shaft
Motorwelle **AISI 430 F**

Tenuta Meccanica
Mechanical Seal
Gleitringdichtung **GRAFITE/CERAMICA**
CARBON/CERAMIC
KOHLE/KERAMIK

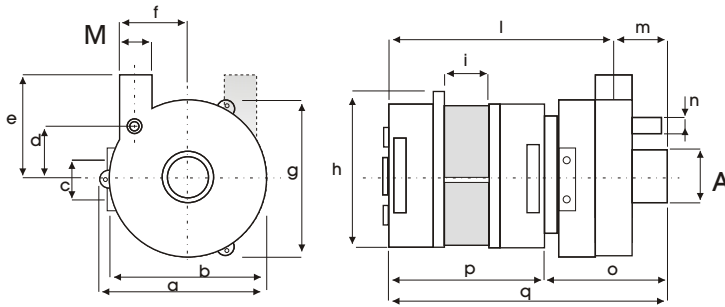

SX	A	M	DX	A	M
	L3: 28	28		L3: 28	28

mod	a	b	c	d	e	f	g	h	i	l	m	n	o	p	q	kg
ZF 130	104	98	24	32,5	67	28	96	102	40	159	37	12	77	119	196	2,8

REVISIONE N.03.01/03

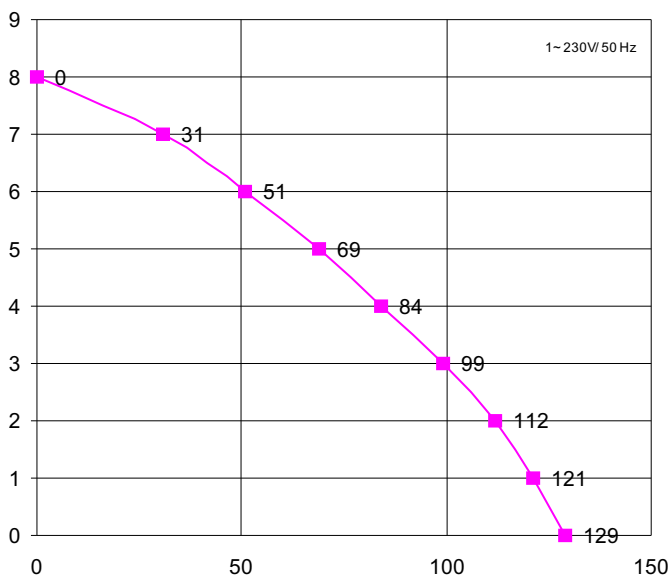

H m	0	1	2	3	4	5	6	7	8
L / 1'	129	121	112	99	84	69	51	31	0

Potenza motore Hp **0,40** kW **0,30**
Motor power
Motor Leistung

Tensione/Frequenza **1~V/Hz**
Tension/Frequency
Spannung/Frequenz **230/50**

Corrente assorbita **A**
Power consumption
Stromaufnahme **1,39**

GPM
RPM **2800**
UPM

Condensatore
Capacitor
Kondensator **6,3 µF**

Protezione termica
Thermal Overload
Überlastschutz **155 °C**

Classe isolamento
Insulation class
Isolationsklasse **F**

Grado protezione
Protection class
Schutzklasse **IP 00**

Servizio **S1** **CONTINUO**
Duty **CONTINUOUS**
Betriebsart **DAUERBETRIEB**

Ci riserviamo il diritto di apportare modi fiche tecniche
We reserve the right of technical modifications
Technische Änderungen vorbehalten



ZF 130B kW 0.30 Hm 6.5 max Hp 0.40 L/1' 116 max



Corpo Pompa Pump Body Pumpengehäuse	PP 30 GF
Girante Aperta Open Impeller Offenes Laufrad	SPS G30 pbØ73
Albero Motore Motor Shaft Motorwelle	AISI 430 F
Tenuta Meccanica Mechanical Seal Gleitringdichtung	GRAFITE/CERAMICA CARBON/CERAMIC KOHLE/KERAMIK

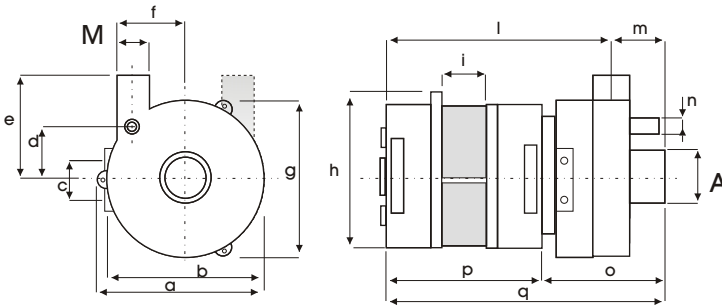

SX	A	M	DX	A	M
	L3: 28	28		L3: 28	28

mod	a	b	c	d	e	f	g	h	i	l	m	n	o	p	q	kg
ZF 130	104	98	24	32,5	67	28	96	102	40	159	37	12	77	119	196	2,8

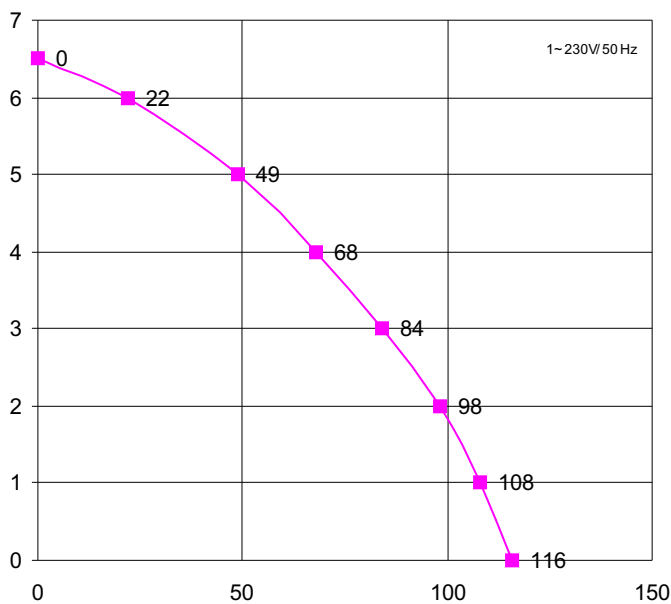

H m	0	1	2	3	4	5	6	6,5
L / 1'	116	108	98	84	68	49	22	0

Potenza motore Motor power Motor Leistung	Hp kW 0,40 0,30
Tensione/Frequenza Tension/Frequency Spannung/Frequenz	1~V/Hz 230/50
Corrente assorbita Power consumption Stromaufnahme	A 1,39
GPM RPM UPM	2800
Condensatore Capacitor Kondensator	6,3 µF
Protezione termica Thermal Overload Überlastschutz	155 °C
Classe isolamento Insulation class Isolationsklasse	F
Grado protezione Protection class Schutzklasse	IP 00
Servizio Duty Betriebsart	S1 CONTINUO CONTINUOS DAUERBETRIEB

Ci riserviamo il diritto di apportare modifiche tecniche
We reserve the right of technical modifications
Technische Änderungen vorbehalten



ZF 130C

kW 0.30 Hm 7.0 max
Hp 0.40 L/1'112 max



Corpo Pompa
Pump Body
Pumpengehäuse **PP 30 GF**

Girante Chiusa
Closed Impeller
Geschl. Laufrad **PPO 20GF**

Albero Motore
Motor Shaft
Motorwelle **AISI 430 F**

Tenuta Meccanica
Mechanical Seal
Gleitringdichtung **GRAFITE/CERAMICA**
CARBON/CERAMIC
KOHLE/KERAMIK

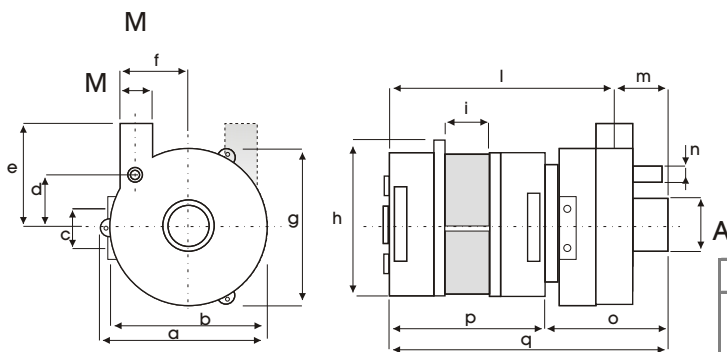

SX	A	M	DX	A	M
	28	28		28	28

mod	a	b	c	d	e	f	g	h	i	l	m	n	o	p	q	kg
ZF 130	104	98	24	32,5	67	28	96	102	40	159	37	12	77	119	196	2,8

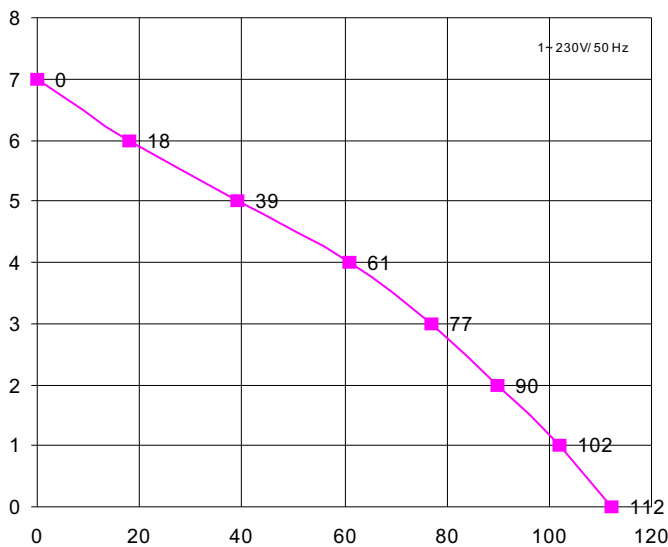

H m	0	1	2	3	4	5	6	7
L / 1'	112	102	90	77	61	39	18	0

Ci riserviamo il diritto di apportare modi fiche tecniche
We reserve the right of technical modifications
Technische Änderungen vorbehalten

Potenza motore
Motor power
Motor Leistung **Hp kW**
0,40 0,30

Tensione/Frequenza
Tension/Frequency
Spannung/Frequenz **1~V/Hz**
230/50

Corrente assorbita
Power consumption
Stromaufnahme **A**
1,39

GPM
RPM
UPM **2800**

Condensatore
Capacitor
Kondensator **6,3 µF**

Protezione termica
Thermal Overload
Überlastschutz **155 °C**

Classe isolamento
Insulation class
Isolationsklasse **F**

Grado protezione
Protection class
Schutzklasse **IP 00**

Servizio
Duty
Betriebsart **S1** **CONTINUO**
CONTINUOS
DAUERBETRIEB

REVISIONE N.03.01/03



ZF 131A

kW 0.21 Hm 7 max
Hp 0.28 L/1' 127 max





Corpo Pompa
Pump Body
Pumpengehäuse **PP 30 GF**

Girante Aperta
Open Impeller
Offenes Laufrad **SPS G30**

Albero Motore
Motor Shaft
Motorwelle **AISI 430 F**

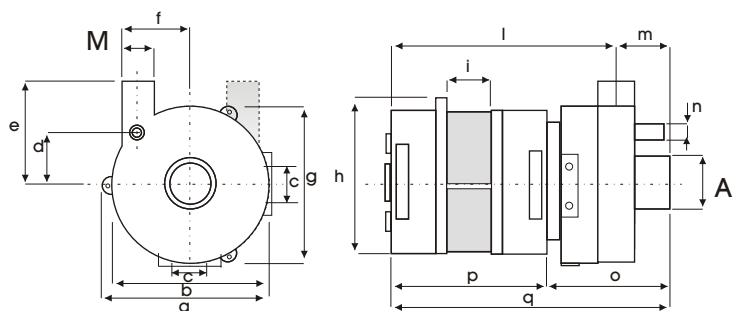
Tenuta Meccanica
Mechanical Seal
Gleitringdichtung **GRAFITE/CERAMICA**
CARBON/CERAMIC
KOHLE/KERAMIK



SX	A	M	DX	A	M
 L3:	28	28	 L3:	28	28

mod	a	b	c	d	e	f	g	h	i	l	m	n	o	p	q	kg
ZF 131	94	91	25	27	67	32,5	91	102	38	159	38	12	78	119	197	2,8

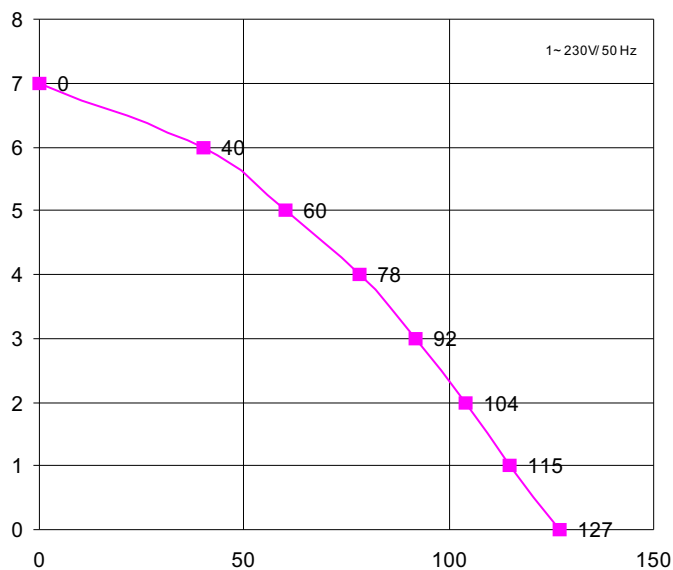

H m	0	1	2	3	4	5	6	7
L / 1'	127	115	104	92	78	60	40	0

Ci riserviamo il diritto di apportare modifiche tecniche
We reserve the right of technical modifications
Technische Änderungen vorbehalten

Potenza motore
Motor power
Motor Leistung **Hp kW**
0,28 0,21

Tensione/Frequenza
Tension/Frequency
Spannung/Frequenz **1~V/Hz**
230/50

Corrente assorbita
Power consumption
Stromaufnahme **A**
1,1

GPM
RPM
UPM **2800**

Condensatore
Capacitor
Kondensator **6,3 µF**

Protezione termica
Thermal Overload
Überlastschutz **155 °C**

Classe isolamento
Insulation class
Isolationsklasse **F**

Grado protezione
Protection class
Schutzklasse **IP 00**

Servizio
Duty
Betriebsart **S1** **CONTINUO**
CONTINUOS
DAUERBETRIEB



ZF 131C

kW 0.21 Hm 7.5 max
Hp 0.28 L/1' 120 max





Corpo Pompa
Pump Body
Pumpengehäuse **PP 30 GF**

Girante Chiusa
Closed Impeller
Geschl. Laufrad **PPO 20GF**

Albero Motore
Motor Shaft
Motorwelle **AISI 430 F**

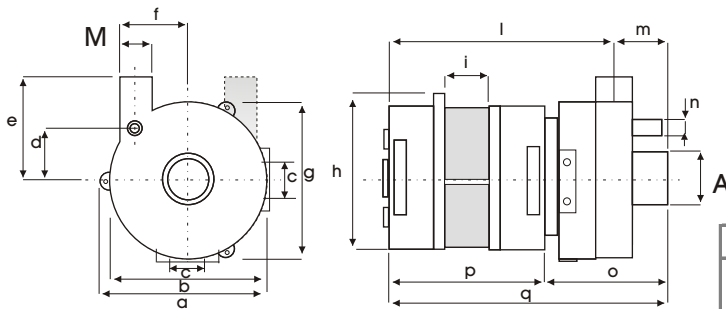
Tenuta Meccanica
Mechanical Seal
Gleitringdichtung **GRAFITE/CERAMICA**
CARBON/CERAMIC
KOHLE/KERAMIK



SX	A	M	DX	A	M
 L3:	28	28	 L3:	28	28

REVISIONE N.03.01/03

mod	a	b	c	d	e	f	g	h	i	l	m	n	o	p	q	kg
ZF 131	94	91	25	27	67	32,5	91	102	38	159	38	12	78	119	197	2,8

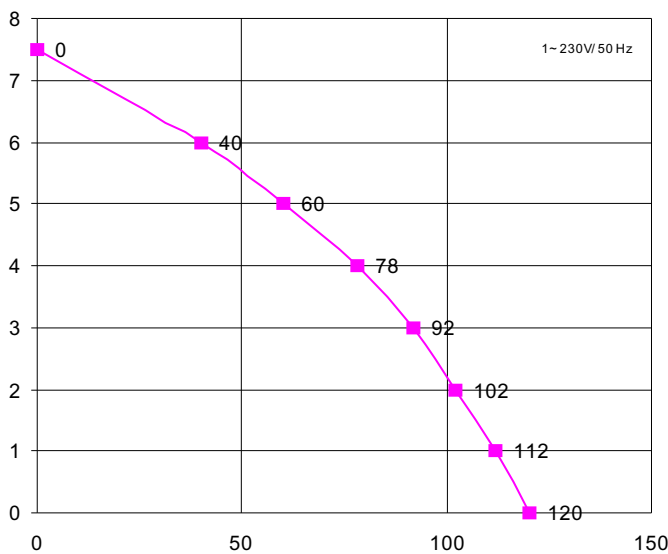

H m	0	1	2	3	4	5	6	7,5
L / 1'	120	112	102	92	78	60	40	0

Potenza motore Hp **0,28** kW **0,21**
Motor power
Motor Leistung

Tensione/Frequenza 1-V/Hz
Tension/Frequency
Spannung/Frequenz **230/50**

Corrente assorbita A
Power consumption
Stromaufnahme **1,1**

GPM
RPM
UPM **2800**

Condensatore **6,3 µF**
Capacitor
Kondensator

Protezione termica **155 °C**
Thermal Overload
Überlastschutz

Classe isolamento **F**
Insulation class
Isolationsklasse

Grado protezione **IP 00**
Protection class
Schutzklasse

Servizio **S1** **CONTINUO**
Duty **CONTINUOUS**
Betriebsart **DAUERBETRIEB**

Ci riserviamo il diritto di apportare modifiche tecniche
We reserve the right of technical modifications
Technische Änderungen vorbehalten



ZF 135

kW 0.34 Hm 9.0 max
Hp 0.46 L/1' 138 max

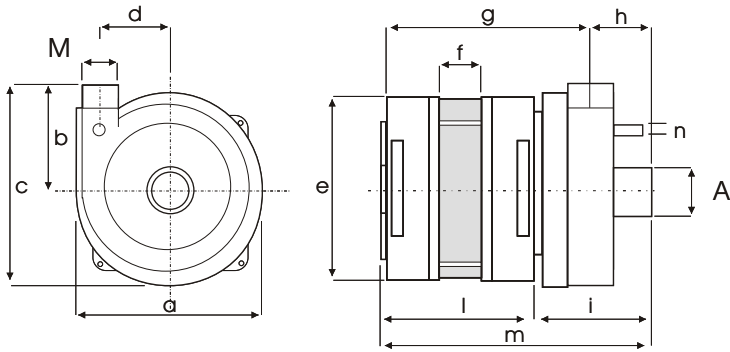

Corpo Pompa Pump Body Pumpengehäuse	PP 30GF
Girante Aperta Open Impeller Offenes Laufrad	PPO 20GF
Albero Motore Motor Shaft Motorwelle	C 40
Tenuta Meccanica Mechanical Seal Gleitringdichtung	GRAFITE/CERAMICA CARBON/CERAMIC KOHLE/KERAMIK

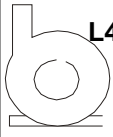
SX	A	M
 L4:	30	30

mod	a	b	c	d	e	f	g	h	i	l	m	n	kg
ZF 135	136	75	143	49	135	40	157	41	80	118	199	12	4,0

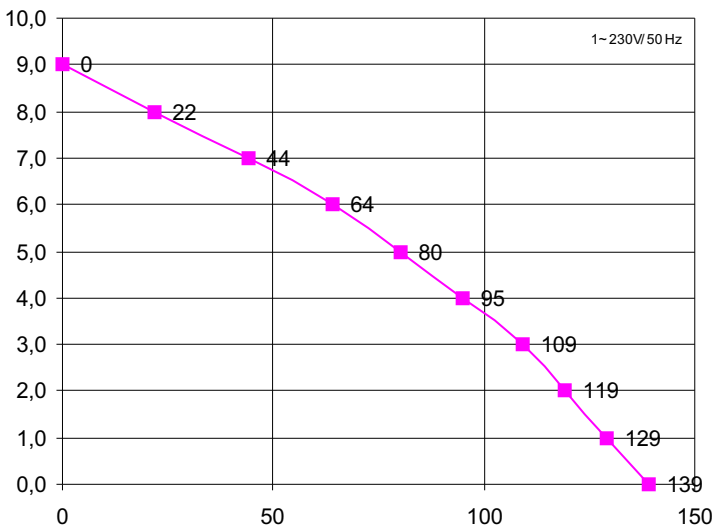

H m	0	1	2	3	5	7	8	9
L / 1'	139	129	119	109	80	44	22	0

Potenza motore Motor power Motor Leistung	Hp 0,46	kW 0,34
Tensione/Frequenza Tension/Frequency Spannung/Frequenz	1~V/Hz 230/50	
Corrente assorbita Power consumption Stromaufnahme	A 1,54	
GPM RPM UPM	2800	
Condensatore Capacitor Kondensator	8 µF	
Protezione termica Thermal Overload Überlastschutz	155 °C	
Classe isolamento Insulation class Isolationsklasse	F	
Grado protezione Protection class Schutzklasse	IP 00	
Servizio Duty Betriebsart	S1	CONTINUO CONTINUOS DAUERBETRIEB

Ci riserviamo il diritto di apportare modifiche tecniche
We reserve the right of technical modifications
Technische Änderungen vorbehalten



ZF 140

kW 0.36 Hm 9.5 max
Hp 0.48 L/1' 129 max



Corpo Pompa
Pump Body
Pumpengehäuse **PP 30GF / PPO 20GF**

Girante Chiusa
Closed Impeller
Geschlossenes Laufrad **PPO 20GF**

Albero Motore
Motor Shaft
Motorwelle **C 40**

Tenuta Meccanica
Mechanical Seal
Gleitringdichtung **GRAFITE/CERAMICA
CARBON/CERAMIC
KOHLE/KERAMIK**

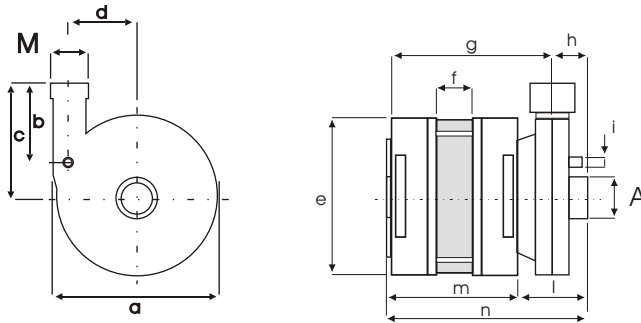

	SX	A	M
		30	30

mod	a	b	c	d	e	f	g	h	i	l	m	n			kg
ZF 140	118	55	85	47,5	135	34	156	39	12,5	77	120	195			3,92

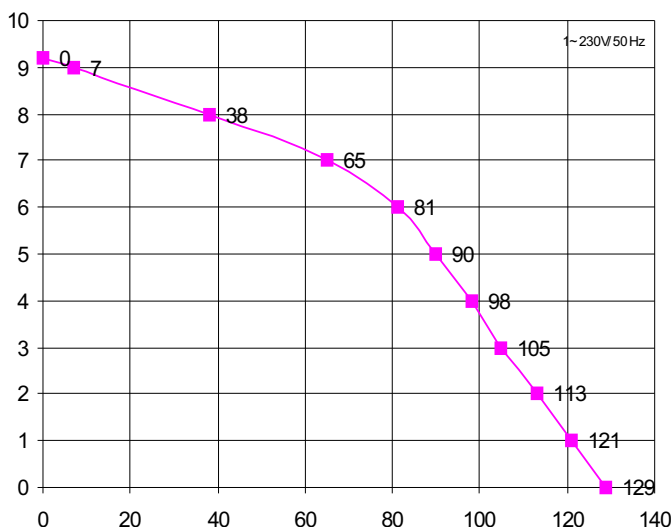

H m	0	2	3	4	5	6	7	8	9,5
L / 1'	129	113	105	98	90	81	65	38	0

Ci riserviamo il diritto di apportare modifiche tecniche
We reserve the right of technical modifications
Technische Änderungen vorbehalten

Potenza motore
Motor power
Motor Leistung **Hp kW**
0,48 0,36

Tensione/Frequenza
Tension/Frequency
Spannung/Frequenz **1~V/Hz**
230/50

Corrente assorbita
Power consumption
Stromaufnahme **A**
1,83

GPM
RPM
UPM **2800**

Condensatore
Capacitor
Kondensator **5 µF**

Protezione termica
Thermal Overload
Überlastschutz **155 °C**

Classe isolamento
Insulation class
Isolationsklasse **F**

Grado protezione
Protection class
Schutzklasse **IP 00**

Servizio
Duty
Betriebsart **S1** **CONTINUO
CONTINUOUS
DAUERBETRIEB**



ZF 150

kW 0.27 Hm 8.1 max
Hp 0.36 L/1' 158 max



Corpo Pompa
Pump Body
Pumpengehäuse **PP 30 GF**

Girante Aperta
Open Impeller Ø75
Offenes Laufrad **PPO 20 GF**

Albero Motore
Motor Shaft
Motorwelle **C 40**

Tenuta Meccanica
Mechanical Seal
Gleitringdichtung **GRAFITE/CERAMICA
CARBON/CERAMIC
KOHLE/KERAMIK**

Vedi Parte n.7 - ACCESSORI per STAFFAGGIO
See Part n. 7 - ACCESSORIES for SUPPORTS
Siehe Teil Nr.7 - ZUBEHÖR - für BEFESTIGUNGEN

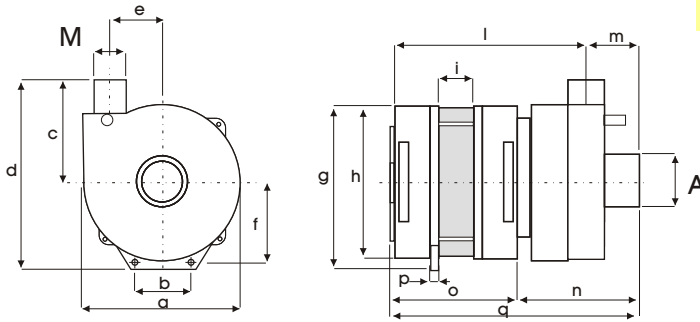

SX	A	M
L4: 	30	30

mod	a	b	c	d	e	f	g	h	i	l	m	n	o	p	q	x	kg
ZF 150	133	58	75	145	45	65	149	130	20	134	41	85	90	6	175	12	3,9

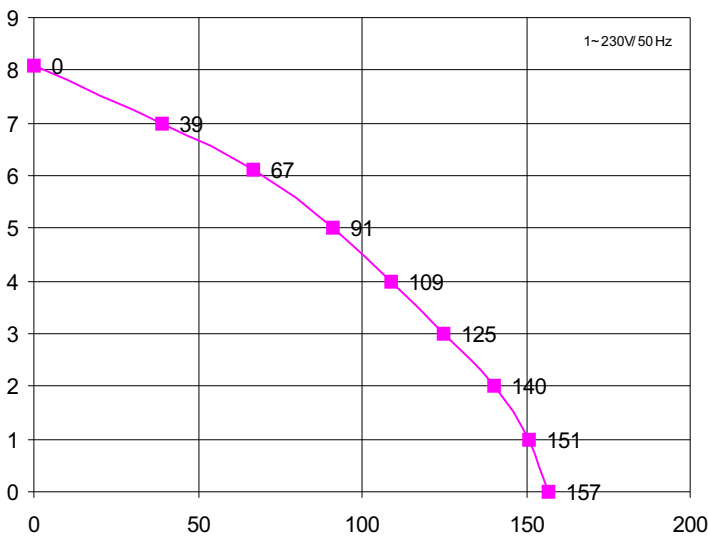

H m	0	1	2	3	4	5	6	7	8,1
L / 1'	157	151	140	125	109	91	67	39	0

Ci riserviamo il diritto di apportare modi fiche tecniche

We reserve the right of technical modifications

Technische Änderungen vorbehalten

Potenza motore
Motor power
Motor Leistung **Hp kW**
0,36 0,27

Tensione/Frequenza
Tension/Frequency
Spannung/Frequenz **1~V/Hz**
230/50

Corrente assorbita
Power consumption
Stromaufnahme **A**
1,17

GPM
RPM
UPM **2800**

Condensatore
Capacitor
Kondensator **8 µF**

Protezione termica
Thermal Overload
Überlastschutz **155 °C**

Classe isolamento
Insulation class
Isolationsklasse **F**

Grado protezione
Protection class
Schutzklasse **IP 00**

Servizio
Duty
Betriebsart **S1** **CONTINUO**
CONTINUOUS
DAUERBETRIEB



ZF 160

kW 0.39 Hm 9.9 max
Hp 0.54 L/1' 176 max



Corpo Pompa
Pump Body
Pumpengehäuse **PP 30GF**

Girante Aperta
Open Impeller Ø85
Offenes Laufrad **PPO 20GF**

Albero Motore
Motor Shaft
Motorwelle **AISI 416**



Tenuta Meccanica
Mechanical Seal
Gleitringdichtung **GRAFITE/CERAMICA**
CARBON/CERAMIC
KOHLE/KERAMIK

Vedi Parte n.7 - ACCESSORI per STAFFAGGIO
See Part n.7 - ACCESSORIES for SUPPORTS
Siehe Teil Nr.7 - ZUBEHÖR - für BEFESTIGUNGEN

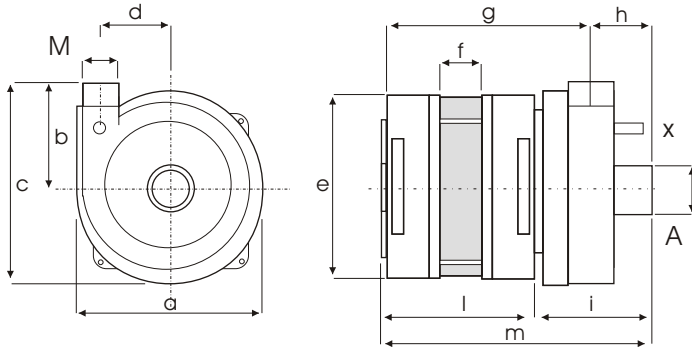

SX	A	M
 L4:	30	30

mod	a	b	c	d	e	f	g	h	i	l	m	x	kg
ZF 160	133	75	139	45	149	30	149	41	85	105	190	12	4,5

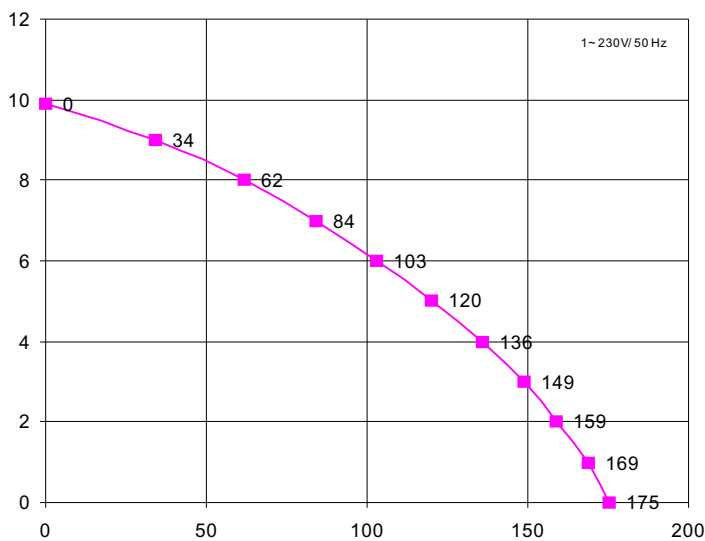

Hm	0	1	2	3	4	5	6	7	8	9,9
L / 1'	175	169	159	149	136	120	103	84	62	0

Ci riserviamo il diritto di apportare modifiche tecniche

We reserve the right of technical modifications

Technische Änderungen vorbehalten

Potenza motore
Motor power
Motor Leistung **Hp kW**
0,54 0,4

Tensione/Frequenza
Tension/Frequency
Spannung/Frequenz **1~V/Hz**
230/50

Corrente assorbita
Power consumption
Stromaufnahme **A**
1,79

GPM
RPM
UPM **2800**

Condensatore
Capacitor
Kondensator **12 µF**

Protezione termica
Thermal Overload
Überlastschutz **155 °C**

Classe isolamento
Insulation class
Isolationsklasse **F**

Grado protezione
Protection class
Schutzklasse **IP 00**

Servizio
Duty
Betriebsart **S1** **CONTINUO**
CONTINUOS
DAUERBETRIEB





ZF 170A

kW 0.30 Hm 7.0 max
Hp 0.40 L/1' 136 max

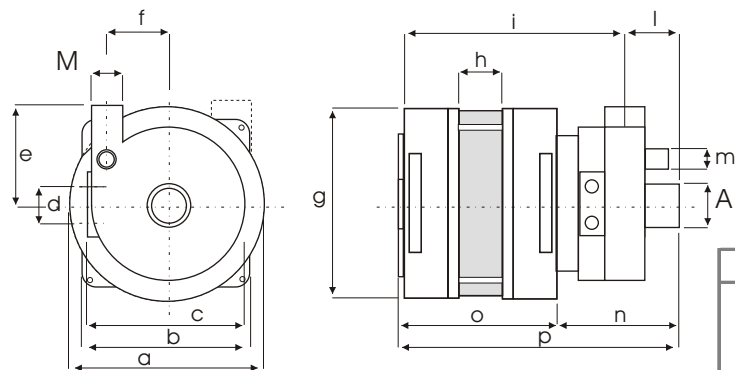

Corpo Pompa Pump Body Pumpengehäuse	PP 30GF
Girante Chiusa Closed Impeller Geschl. Laufrad	SPS 30G pa Ø72
Albero Motore Motor Shaft Motorwelle	AISI 430 F
Tenuta Meccanica Mechanical Seal Gleitringdichtung	GRAFITE/CERAMICA CARBON/CERAMIC KOHLE/KERAMIK



SX	A	M	DX	A	M
 L3:	28	28	 L3:	28	28

mod	a	b	c	d	e	f	g	h	i	l	m	n	o	p	kg
ZF 170	138	115	98	24	67	28	135	30	154	37	12	80	111	191	3,9

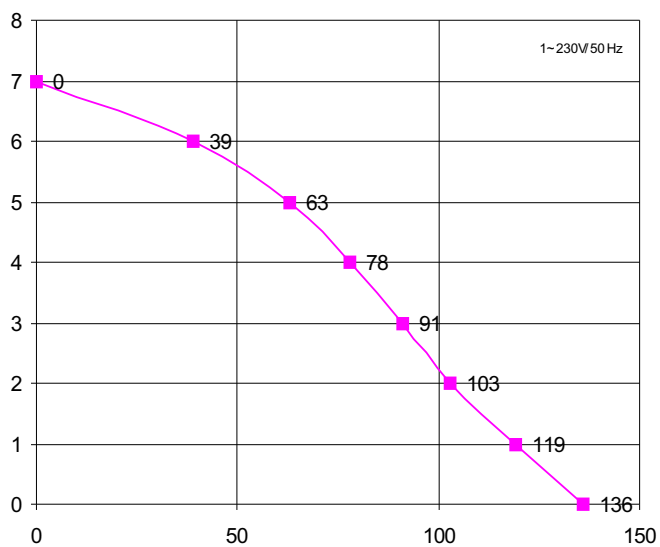

Hm	0	1	2	3	4	5	6	7
L / 1'	136	119	103	91	78	63	39	0

Potenza motore Motor power Motor Leistung	Hp kW 0,40 0,30
Tensione/Frequenza Tension/Frequency Spannung/Frequenz	1~V/Hz 230/50
Corrente assorbita Power consumption Stromaufnahme	A 1,38
GPM RPM UPM	2800
Condensatore Capacitor Kondensator	6,3 µF
Protezione termica Thermal Overload Überlastschutz	155 °C
Classe isolamento Insulation class Isolationsklasse	F
Grado protezione Protection class Schutzklasse	IP 00
Servizio Duty Betriebsart	S1 CONTINUO CONTINUOS DAUERBETRIEB

Ci riserviamo il diritto di apportare modifiche tecniche
We reserve the right of technical modifications
Technische Änderungen vorbehalten





ZF 170B

kW 0.30 Hm 7.5 max
Hp 0.40 L/1' 138 max

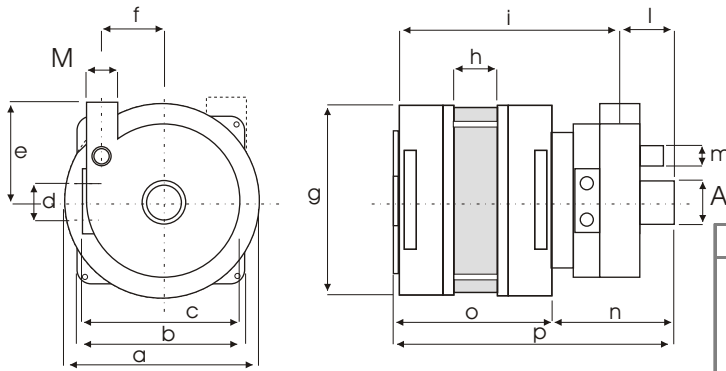

Corpo Pompa <i>Pump Body</i> Pumpengehäuse	PP 30GF
Girante Aperta <i>Open Impeller</i> Offenes Laufrad	PPO 20GF pa Ø72
Albero Motore <i>Motor Shaft</i> Motorwelle	AISI 430 F
Tenuta Meccanica <i>Mechanical Seal</i> Gleitringdichtung	GRAFITE/CERAMICA CARBON/CERAMIC KOHLE/KERAMIK



SX	A	M	DX	A	M
 L3:	28	28	 L3:	28	28

mod	a	b	c	d	e	f	g	h	i	l	m	n	o	p	kg
ZF 170	138	115	98	24	67	28	135	30	154	37	12	80	111	191	3,9

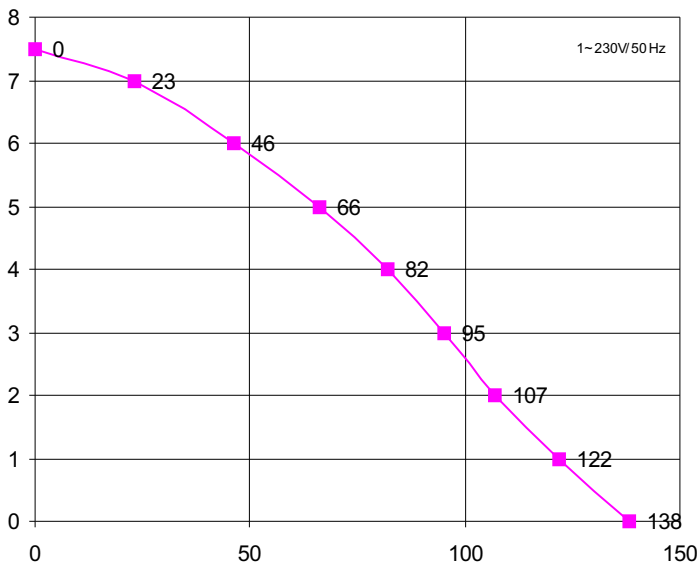

H m	0	1	2	3	4	5	6	7	7,5
L / 1'	138	122	107	95	82	66	46	23	0

Potenza motore Motor power Motor Leistung	Hp 0,40 kW 0,30
Tensione/Frequenza Tension/Frequency Spannung/Frequenz	1~V/Hz 230/50
Corrente assorbita Power consumption Stromaufnahme	A 1,38
GPM RPM UPM	2800
Condensatore Capacitor Kondensator	6,3 µF
Protezione termica Thermal Overload Überlastschutz	155 °C
Classe isolamento Insulation class Isolationsklasse	F
Grado protezione Protection class Schutzklasse	IP 00
Servizio Duty Betriebsart	S1 CONTINUO CONTINUOUS DAUERBETRIEB

REVISIONE N.00.01/03 P58/02

Ci riserviamo il diritto di apportare modifiche tecniche
We reserve the right of technical modifications
Technische Änderungen vorbehalten



ZF 170C

kW 0.30 Hm 7.0 max
Hp 0.40 L/1' 119 max

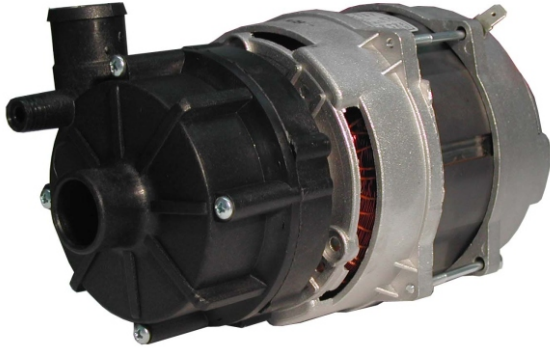

Corpo Pompa Pump Body Pumpengehäuse	PP 30GF
Girante Chiusa Closed Impeller Geschl. Laufrad	PPO 20GF pa Ø72
Albero Motore Motor Shaft Motorwelle	AISI 430 F
Tenuta Meccanica Mechanical Seal Gleitringdichtung	GRAFITE/CERAMICA CARBON/CERAMIC KOHLE/KERAMIK

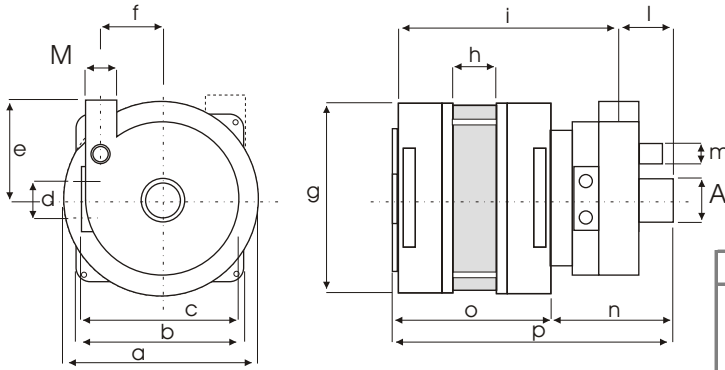

SX	A	M	DX	A	M
	28	28		28	28

mod	a	b	c	d	e	f	g	h	i	l	m	n	o	p	kg
ZF 170	138	115	98	24	67	28	135	30	154	37	12	80	111	191	3,9

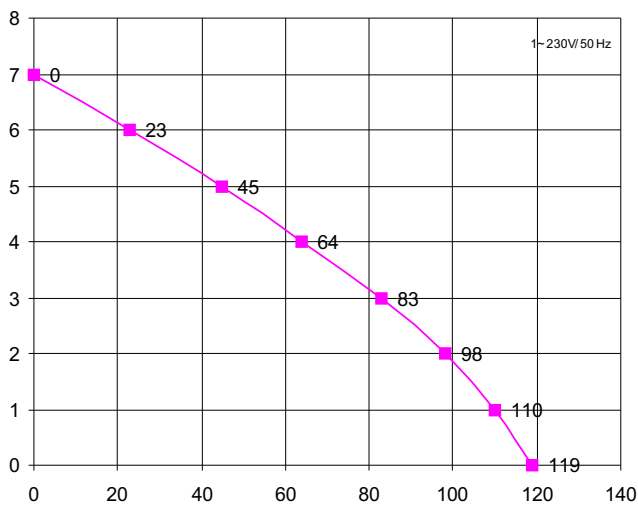

H m	0	1	2	3	4	5	6	7
L / 1'	119	110	98	83	64	45	23	0

Potenza motore Motor power Motor Leistung	Hp kW 0,40 0,30
Tensione/Frequenza Tension/Frequency Spannung/Frequenz	1~V/Hz 230/50
Corrente assorbita Power consumption Stromaufnahme	A 1,38
GPM RPM UPM	2800
Condensatore Capacitor Kondensator	6,3 µF
Protezione termica Thermal Overload Überlastschutz	155 °C
Classe isolamento Insulation class Isolationsklasse	F
Grado protezione Protection class Schutzklasse	IP 00
Servizio Duty Betriebsart	S1 CONTINUO CONTINUOS DAUERBETRIEB

Ci riserviamo il diritto di apportare modifiche tecniche
We reserve the right of technical modifications
Technische Änderungen vorbehalten



ZF 171A

kW 0.29 Hm 7.0 max
Hp 0.38 L/1' 130 max



Corpo Pompa Pump Body Pumpengehäuse	PP 30GF
Girante Aperta Open Impeller Offenes Laufrad	SPS 30G Ø72
Albero Motore Motor Shaft Motorwelle	C 40
Tenuta Meccanica Mechanical Seal Gleitringdichtung	GRAFITE/CERAMICA CARBON/CERAMIC KOHLE/KERAMIK

REVISIONE N.00.01/03 P57/02

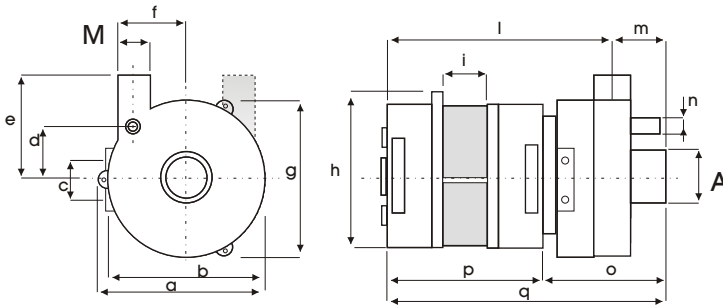

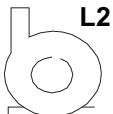
SX	A	M
	L2: 25	25

mod	a	b	c	d	e	f	g	h	i	l	m	n	o	p	kg
ZF 171	94	91	25	27	67	32,5	91	135	34						

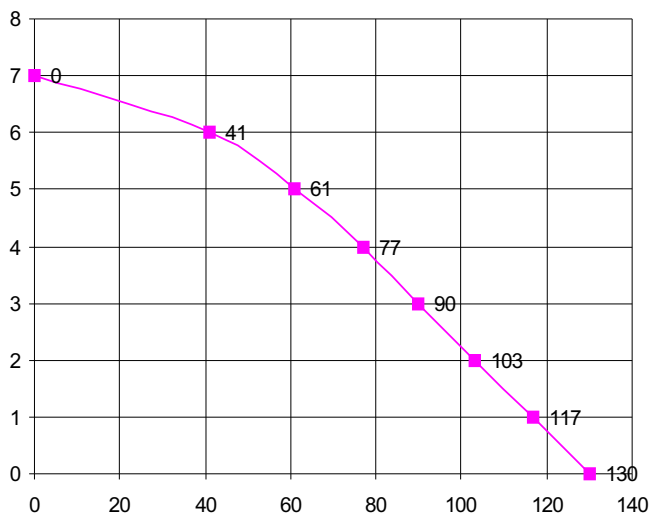

H m	0	1	2	3	4	5	6	7
L / 1'	130	117	103	90	77	61	41	0

Ci riserviamo il diritto di apportare modifiche tecniche
We reserve the right of technical modifications
Technische Änderungen vorbehalten

Potenza motore Motor power Motor Leistung	Hp kW 0,32 0,24
Tensione/Frequenza Tension/Frequency Spannung/Frequenz	1~V/Hz 230/50
Corrente assorbita Power consumption Stromaufnahme	A 1,16
GPM RPM UPM	2800
Condensatore Capacitor Kondensator	8 µF
Protezione termica Thermal Overload Überlastschutz	155 °C
Classe isolamento Insulation class Isolationsklasse	F
Grado protezione Protection class Schutzklasse	IP 00
Servizio Duty Betriebsart	S1 CONTINUO CONTINUOS DAUERBETRIEB



ZF 171C

kW 0.24 Hm 7.0 max
Hp 0.32 L/1' 116 max



Corpo Pompa Pump Body Pumpengehäuse	PP 30GF
Girante Chiusa Closed Impeller Geschl. Laufrad	PPO 20GF Ø71,5
Albero Motore Motor Shaft Motorwelle	C 40
Tenuta Meccanica Mechanical Seal Gleitringdichtung	GRAFITE/CERAMICA CARBON/CERAMIC KOHLE/KERAMIK

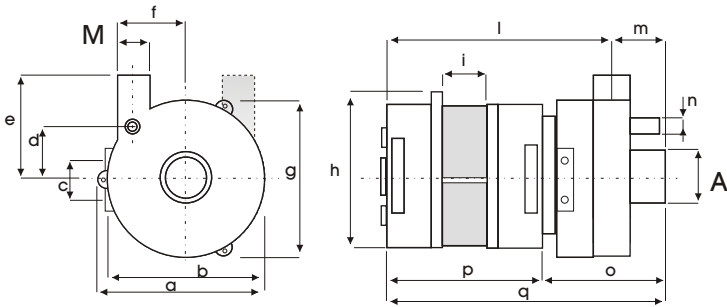

SX	A	M
L2:	25	25

mod	a	b	c	d	e	f	g	h	i	l	m	n	o	p	kg
ZF 171	94	91	25	27	67	32,5	91	135	34						

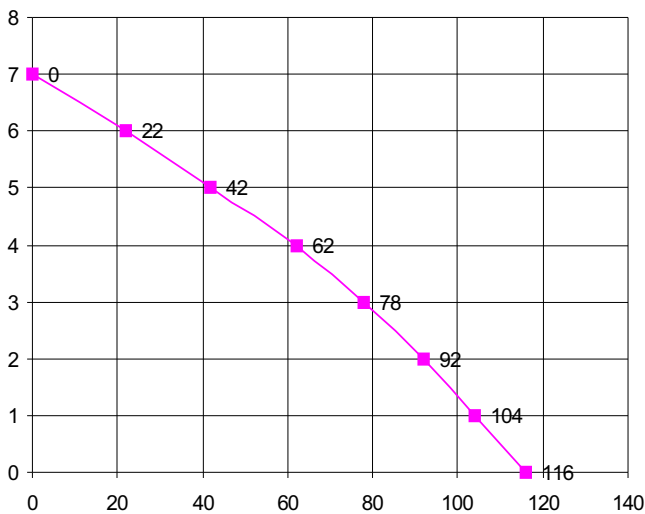

H m	0	1	2	3	4	5	6	7
L / 1'	116	104	92	78	62	42	22	0

Potenza motore Motor power Motor Leistung	Hp kW 0,32 0,24
Tensione/Frequenza Tension/Frequency Spannung/Frequenz	1~V/Hz 230/50
Corrente assorbita Power consumption Stromaufnahme	A 1,16
GPM RPM UPM	2800
Condensatore Capacitor Kondensator	8 µF
Protezione termica Thermal Overload Überlastschutz	155 °C
Classe isolamento Insulation class Isolationsklasse	F
Grado protezione Protection class Schutzklasse	IP 00
Servizio Duty Betriebsart	S1 CONTINUO CONTINUOUS DAUERBETRIEB

REVISIONE N.00.01/03 P57/02

Ci riserviamo il diritto di apportare modifiche tecniche
We reserve the right of technical modifications
Technische Änderungen vorbehalten



ZF 210

kW 0.85
Hp 1.14

Hm 14 max
L/1' 218 max



Corpo Pompa
Pump Body
Pumpengehäuse **PP 30GF / PPO 20GF**

Girante Aperta
Open Impeller
Offenes Laufrad **SPS G30**

Albero Motore
Motor Shaft
Motorwelle **AISI 416**

Tenuta Meccanica
Mechanical Seal
Gleitringdichtung **GRAFITE/CERAMICA**
CARBON/CERAMIC
KOHLE/KERAMIK

Vedi Parte n.7 - ACCESSORI per STAFFAGGIO
See Part n. 7 - ACCESSORIES for SUPPORTS
Siehe Teil Nr.7 - ZUBEHÖR - für BEFESTIGUNGEN

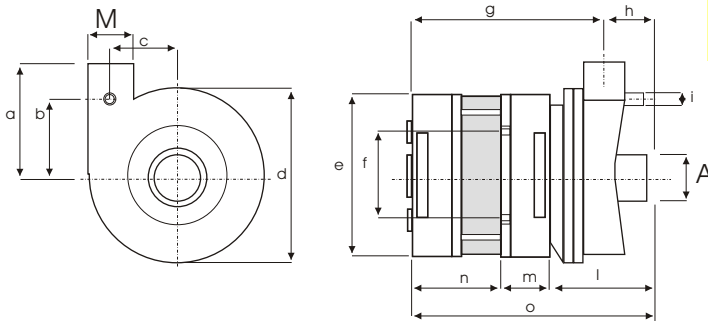

SX	A	M
	L6: 41	31,5
	L7: 45	40
	L9: 50	50
	F3: 1"	1"

mod	a	b	c	d	e	f	g	h	i	l	m	n	o	p	q	r	kg
ZF 210	97	60,5	59	160	149	58	145	34	12	73	34	72	179	-	-	-	5,2

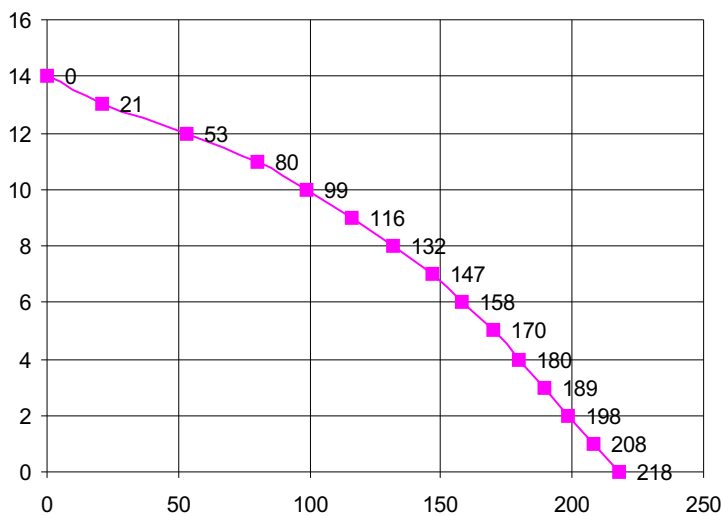

Hm	0	1	3	4	5	6	7	8	10	12	14
L/1'	218	208	189	180	170	158	147	132	99	53	0

Ci riserviamo il diritto di apportare modifiche tecniche

We reserve the right of technical modifications

Technische Änderungen vorbehalten

Potenza motore
Motor power
Motor Leistung **Hp kW**
1,14 0,85

Tensione/Frequenza
Tension/Frequency
Spannung/Frequenz **1~V/Hz**
230/50

Corrente assorbita
Power consumption
Stromaufnahme **A**
3,7

GPM
RPM
UPM **2800**

Condensatore
Capacitor
Kondensator **12,5 µF**

Protezione termica
Thermal Overload
Überlastschutz **155 °C**

Classe isolamento
Insulation class
Isolationsklasse **F**

Grado protezione
Protection class
Schutzklasse **IP 00**

Servizio
Duty
Betriebsart **S1** **CONTINUO**
CONTINUOUS
DAUERBETRIEB



ZF 220

kW 0.91 Hm 11.0 max
Hp 1.22 L/1' 374 max



Corpo pompa
Pump Body
Pumpengehäuse **PP 30GF**

Girante chiusa
Closed Impeller
Geschl. Laufrad **PPO 20GF**

Albero motore
Motor Shaft
Motorwelle **AISI 416**

Tenuta meccanica
Mechanical Seal
Gleitringdichtung **GRAFITE/CERAMICA**
CARBON/CERAMIC
KOEHLE/KERAMIK

Vedi Parte n.7 - ACCESSORI per STAFFAGGIO
See Part n. 7 - ACCESSORIES for SUPPORTS
Siehe Teil Nr.7 - ZUBEHÖR - für BEFESTIGUNGEN

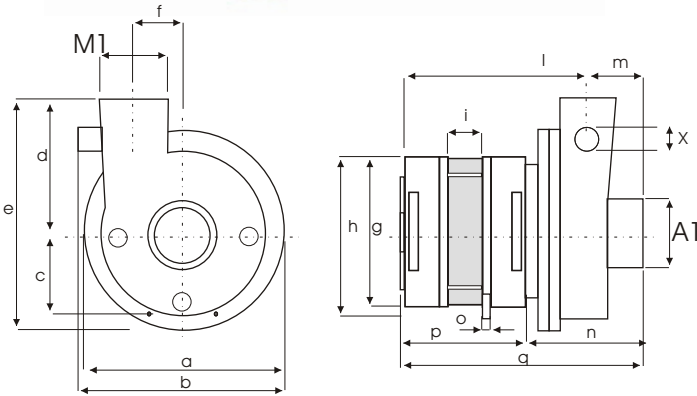

SX	A	M
L7:	45	40

mod	a	b	c	d	e	f	g	h	i	l	m	n	o	p	q	x	kg
ZF 220	140	152	71	70	141	48	147	149	50	153	40	81	6	115	220	18	5,5

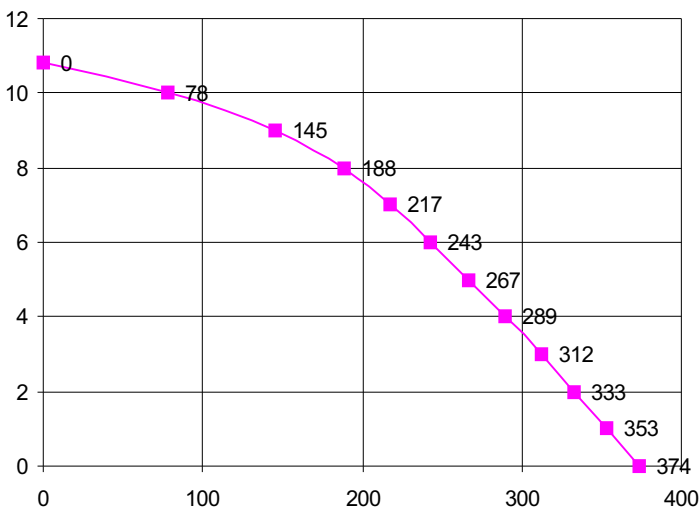

Hm	0	1	2	3	4	5	6	7	8	9	10	11
L/1'	374	353	333	312	289	267	243	217	188	145	78	0

Potenza motore
Motor power
Motor Leistung **Hp kW**
1,22 0,91

Tensione/Frequenza
Tension/Frequency
Spannung/Frequenz **1~V/Hz**
230/50

Corrente assorbita
Power consumption
Stromaufnahme **A**
3,98

GPM
RPM
UPM **2800**

Condensatore
Capacitor
Kondensator **16 µF**

Protezione termica
Thermal Overload
Überlastschutz **155 °C**

Classe isolamento
Insulation class
Isolationsklasse **F**

Grado protezione
Protection class
Schutzklasse **IP 00**

Servizio
Duty
Betriebsart **S1** **CONTINUO**
CONTINUOS
DAUERBETRIEB

Ci riserviamo il diritto di apportare modifiche tecniche

We reserve the right of technical modifications

Technische Änderungen vorbehalten

REVISIONE N.00.01/03 P133-134/01



ZF 220 V

kW 0.91 Hm 11 max
Hp 1.22 L/1' 374 max



Corpo Pompa
Pump Body
Pumpengehäuse **PP 30GF**

Girante Chiusa
Closed Impeller
Geschl. Laufrad **PPO 20GF**

Albero Motore
Motor Shaft
Motorwelle **AISI 416**

Tenuta Meccanica
Mechanical Seal
Gleitringdichtung **GRAFITE/CERAMICA
CARBON/CERAMIC
KOHLE/KERAMIK**

Vedi Parte n.7 - ACCESSORI per STAFFAGGIO
See Part n. 7 - ACCESSORIES for SUPPORTS
Siehe Teil Nr.7 - ZUBEHÖR - für BEFESTIGUNGEN

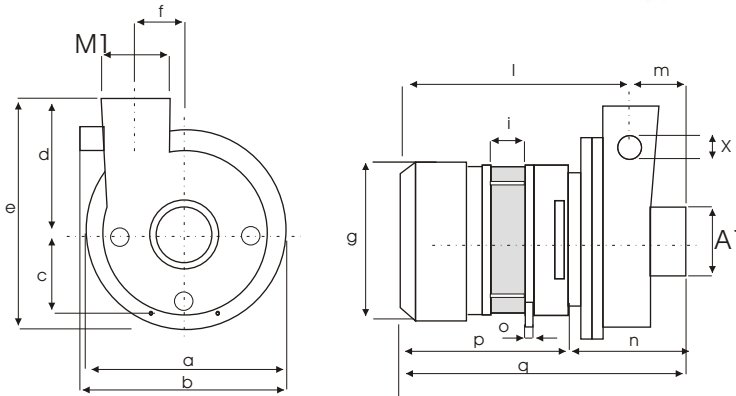

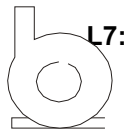
SX	A	M
	L7: 45	40

mod	a	b	c	d	e	f	g	h	i	l	m	n	o	p	q	x	kg
ZF 220 V	140	152	71	70	141	48	142	-	50	190	40	81	6	144	230	18	5,8

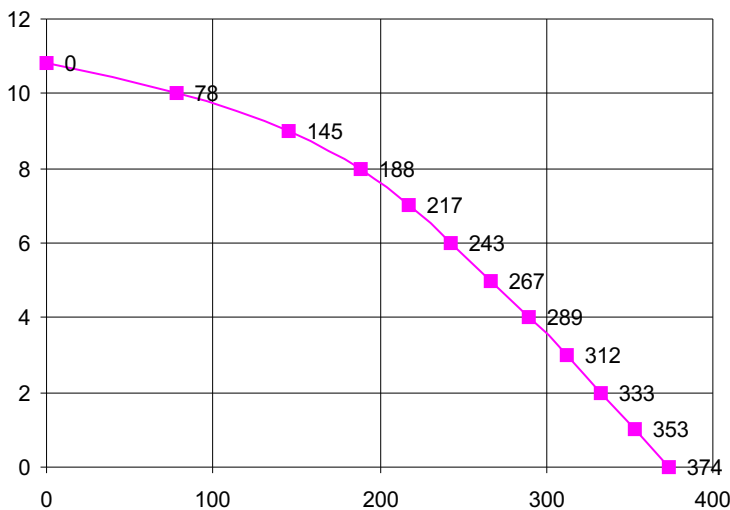

Hm	0	1	2	3	4	5	6	7	8	9	10	11
L/1'	374	353	333	312	289	267	243	217	188	145	78	0

Ci riserviamo il diritto di apportare modifiche tecniche

We reserve the right of technical modifications

Technische Änderungen vorbehalten

Potenza motore **Hp kW**
Motor power **1,22 0,91**
Motor Leistung

Tensione/Frequenza **1~V/Hz**
Tension/Frequency **230/50**
Spannung/Frequenz

Corrente assorbita **A**
Power consumption **3,98**
Stromaufnahme

GPM **2800**
RPM
UPM

Condensatore **16 µF**
Capacitor
Kondensator

Protezione termica **155 °C**
Thermal Overload
Überlastschutz

Classe isolamento **F**
Insulation class
Isolationsklasse

Grado protezione **IP 00**
Protection class
Schutzklasse

Servizio **S1** **CONTINUO**
Duty **CONTINUOUS**
Betriebsart **DAUERBETRIEB**



ZF 270

kW 0.38 Hm 7.0 max
Hp 0.51 L/1' 266 max



Corpo Pompa
Pump Body
Pumpengehäuse **PP 30GF**

Girante Aperta
Open Impeller
Offenes Laufrad **SPS G30**

Albero Motore
Motor Shaft
Motorwelle **AISI 416**

Tenuta Meccanica
Mechanical Seal
Gleitringdichtung **GRAFITE/CERAMICA
CARBON/CERAMIC
KOHLE/KERAMIK**

Vedi Parte n.7 - ACCESSORI per STAFFAGGIO
See Part n. 7 - ACCESSORIES for SUPPORTS
Siehe Teil Nr.7 - ZUBEHÖR - für BEFESTIGUNGEN

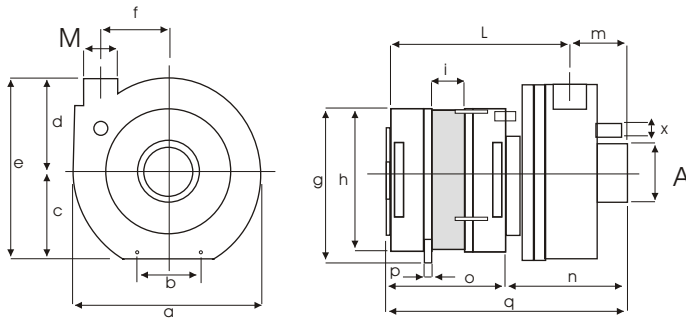

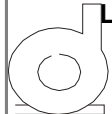
SX	A	M	DX	A	M
 L7:	45	40	 L7:	45	40

mod	a	b	c	d	e	f	g	h	i	l	m	n	o	p	q	x	kg
ZF 270	170	58	70	75	150	57	149	130	25	146	44	95	95	6	190	12	5,4

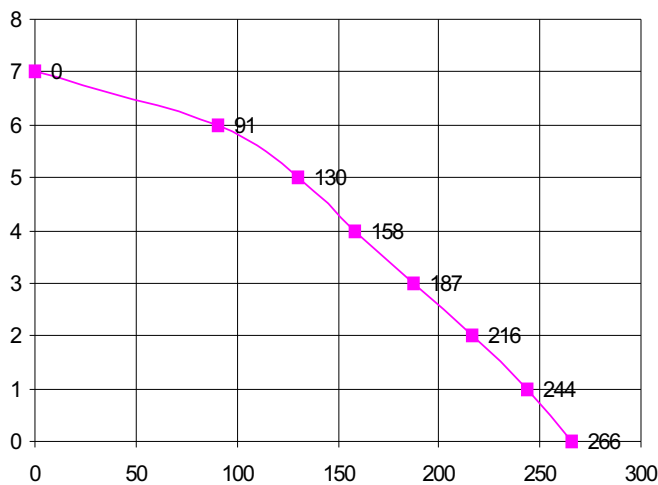

Potenza motore **Hp kW**
Motor power **0,51 0,38**
Motor Leistung

Tensione/Frequenza **1~V/Hz**
Tension/Frequency **230/50**
Spannung/Frequenz

Corrente assorbita **A**
Power consumption **1,69**
Stromaufnahme

GPM **2800**
RPM
UPM

Condensatore **10 µF**
Capacitor
Kondensator

Protezione termica **155 °C**
Thermal Overload
Überlastschutz

Classe isolamento **F**
Insulation class
Isolationsklasse

Grado protezione **IP 00**
Protection class
Schutzklasse

Servizio **S1** **CONTINUO**
Duty **CONTINUOS**
Betriebsart **DAUERBETRIEB**

Ci riserviamo il diritto di apportare modi fiche tecniche

We reserve the right of technical modifications

Technische Änderungen vorbehalten

REVISIONE N.00.01/03 P04/03



ZF 270 V

kW 0.38 Hm 7.0 max
Hp 0.51 L/1' 266 max



Corpo Pompa Pump Body Pumpengehäuse	PP 30GF
Girante Aperta Open Impeller Offenes Laufrad	SPS G30
Albero Motore Motor Shaft Motorwelle	AINI 416
Tenuta Meccanica Mechanical Seal Gleitringdichtung	GRAFITE/CERAMICA CARBON/CERAMIC KOHLE/KERAMIK

Vedi Parte n.7 - ACCESSORI per STAFFAGGIO
See Part n. 7 - ACCESSORIES for SUPPORTS
Siehe Teil Nr.7 - ZUBEHÖR - für BEFESTIGUNGEN

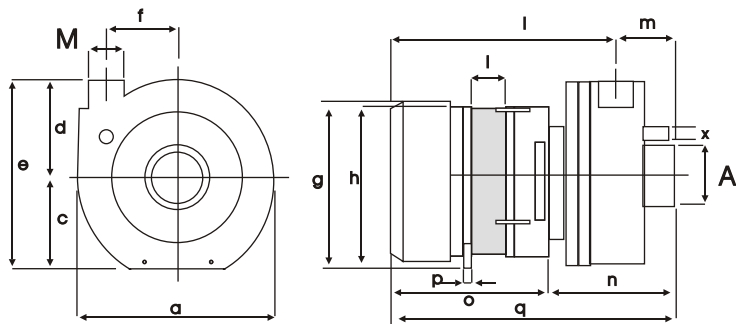

SX	A	M	DX	A	M
L7:	45	40	L7:	45	40

mod	a	b	c	d	e	f	g	h	i	l	m	n	o	p	q	x	kg
ZF 270V	170	58	70	75	150	57	149	130	25	176	44	95	125	6	220	12	5,5

REVISIONE N.00.01/03 P04/03

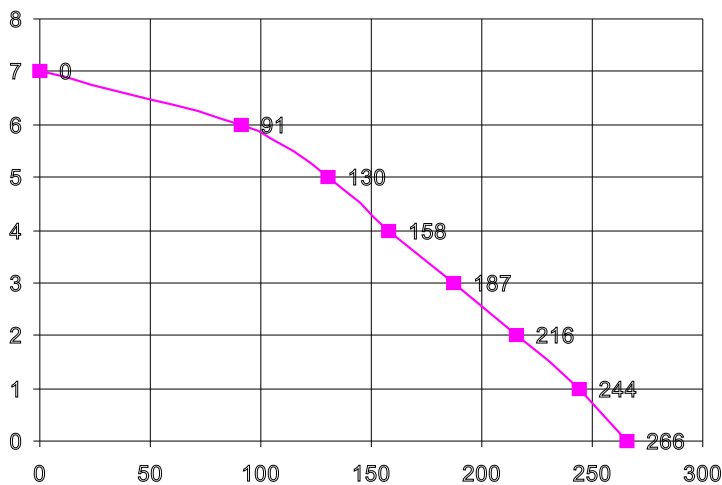

H m	0	2	4	5	6	7
L / 1'	266	216	158	130	91	0

Ci riserviamo il diritto di apportare modifiche tecniche
We reserve the right of technical modifications
Technische Änderungen vorbehalten

Potenza motore Motor power Motor Leistung	Hp kW 0,51 0,38
Tensione/Frequenza Tension/Frequency Spannung/Frequenz	1~V/Hz 230/50
Corrente assorbita Power consumption Stromaufnahme	A 1,69
GPM RPM UPM	2800
Condensatore Capacitor Kondensator	10 µF
Protezione termica Thermal Overload Überlastschutz	155 °C
Classe isolamento Insulation class Isolationsklasse	F
Grado protezione Protection class Schutzklasse	IP 00
Servizio Duty Betriebsart	S1 CONTINUO CONTINUOUS DAUERBETRIEB



ZF 290

kW 0.70 Hm 9.0 max
Hp 0.94 L/1' 356 max



Corpo Pompa Pump Body Pumpengehäuse	PP 30GF
Girante Aperta Open Impeller Offenes Laufrad	SPS G30
Albero Motore Motor Shaft Motorwelle	AISI 416
Tenuta Meccanica Mechanical Seal Gleitringdichtung	GRAFITE/CERAMICA CARBON/CERAMIC KOHLE/KERAMIK

Vedi Parte n.7 - ACCESSORI per STAFFAGGIO
See Part n. 7 - ACCESSORIES for SUPPORTS
Siehe Teil Nr.7 - ZUBEHÖR - für BEFESTIGUNGEN

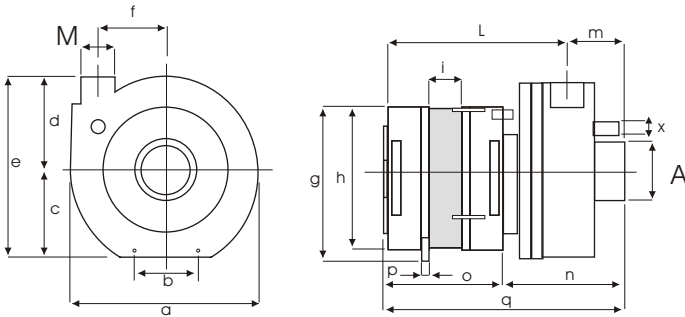

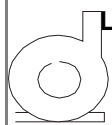
SX	A	M	DX	A	M
 L7:	45	40	 L7:	45	40

mod	a	b	c	d	e	f	g	h	i	l	m	n	o	p	q	x	kg
ZF 290	170	58	70	75	150	57	149	130	35	156	44	95	105	6	200	12	5,6

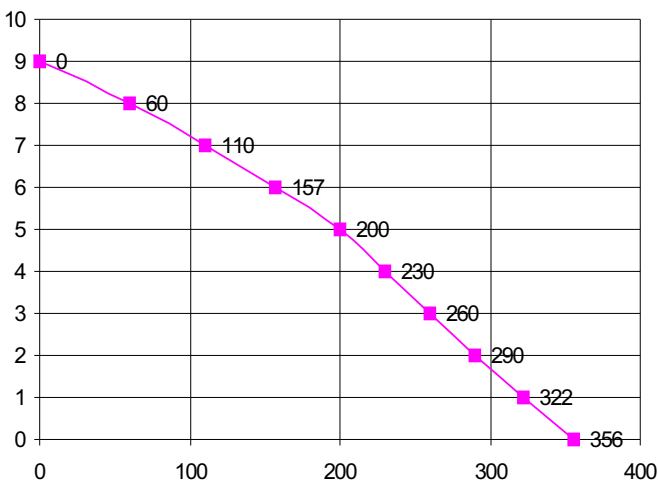

H m	0	2	4	5	6	7	8	9
L / 1'	356	322	230	200	157	110	60	0

Ci riserviamo il diritto di apportare m odifiche tecniche
We reserve the right of technic al modifications
Technische Änderungen vorbehalten

Potenza motore Motor power Motor Leistung	Hp kW 0,94 0,70
Tensione/Frequenza Tension/Frequency Spannung/Frequenz	1~V/Hz 230/50
Corrente assorbita Power consumption Stromaufnahme	A 3,0
GPM RPM UPM	2800
Condensatore Capacitor Kondensator	12,5 µF
Protezione termica Thermal Overload Überlastschutz	155 °C
Classe isolamento Insulation class Isolationsklasse	F
Grado protezione Protection class Schutzklasse	IP 00
Servizio Duty Betriebsart	S1 CONTINUO CONTINUOS DAUERBETRIEB



ZF 290 V

kW 0.70 Hm 9.0 max
Hp 0.94 L/1' 356 max



Corpo Pompa
Pump Body
Pumpengehäuse **PP 30GF**

Girante Aperta
Open Impeller
Offenes Laufrad **SPS G30**

Albero Motore
Motor Shaft
Motorwelle **AISI 416**

Tenuta Meccanica
Mechanical Seal
Gleitringdichtung **GRAFITE/CERAMICA
CARBON/CERAMIC
KOHLE/KERAMIK**

Vedi Parte n.7 - ACCESSORI per STAFFAGGIO
See Part n. 7 - ACCESSORIES for SUPPORTS
Siehe Teil Nr.7 - ZUBEHÖR - für BEFESTIGUNGEN

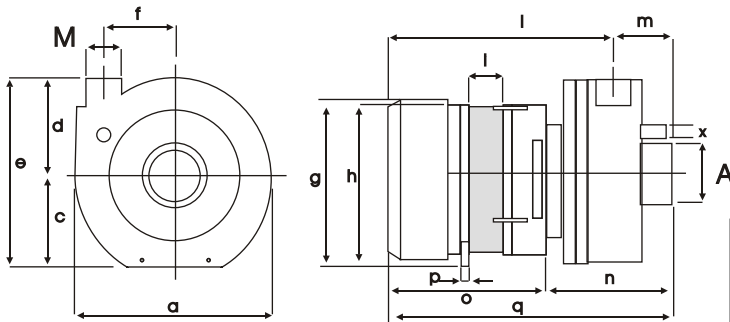

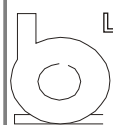
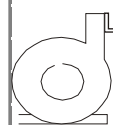
SX	A	M	DX	A	M
 L7:	45	40	 L7:	45	40

mod	a	b	c	d	e	f	g	h	i	l	m	n	o	p	q	x	kg
ZF290V	170	-	70	75	150	57	142	130	35	186	44	95	135	6	230	12	5,7

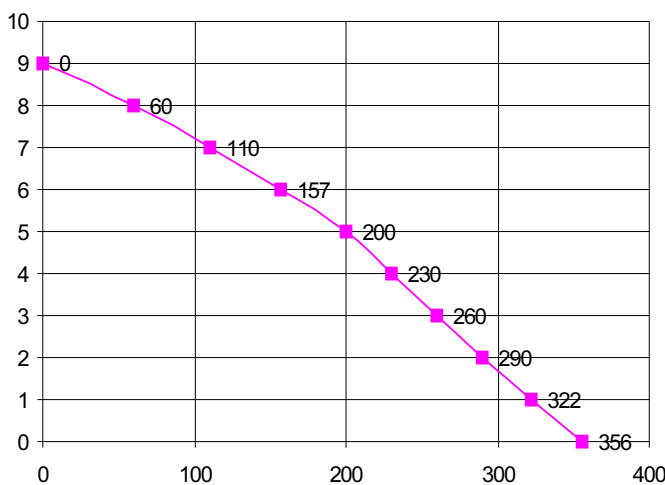

Hm	0	2	4	5	6	7	8	9
L / 1'	356	322	230	200	157	110	60	0

Ci riserviamo il diritto di apportare modifiche tecniche
We reserve the right of technical modifications
Technische Änderungen vorbehalten

Potenza motore
Motor power
Motor Leistung **Hp kW
0,94 0,7**

Tensione/Frequenza
Tension/Frequency
Spannung/Frequenz **1~V/Hz
230/50**

Corrente assorbita
Power consumption
Stromaufnahme **A
3,0**

GPM
RPM
UPM **2800**

Condensatore
Capacitor
Kondensator **12,5 µF**

Protezione termica
Thermal Overload
Überlastschutz **155 °C**

Classe isolamento
Insulation class
Isolationsklasse **F**

Grado protezione
Protection class
Schutzklasse **IP 00**

Servizio
Duty
Betriebsart **S1 CONTINUO
CONTINUOUS
DAUERBETRIEB**



ZF 320

kW 0.67 Hm 11.5 max
Hp 0.91 L/1' 311 max



Corpo Pompa Pump Body Pumpengehäuse	PP 30GF
Girante Aperta Open Impeller Offenes Laufrad	SPS G30
Albero Motore Motor Shaft Motorwelle	AISI 416
Tenuta Meccanica Mechanical Seal Gleitringdichtung	GRAFITE/CERAMICA CARBON/CERAMIC KOHLE/KERAMIK

Vedi Parte n.7 - ACCESSORI per STAFFAGGIO
See Part n. 7 - ACCESSORIES for SUPPORTS
Siehe Teil Nr.7 - ZUBEHÖR - für BEFESTIGUNGEN

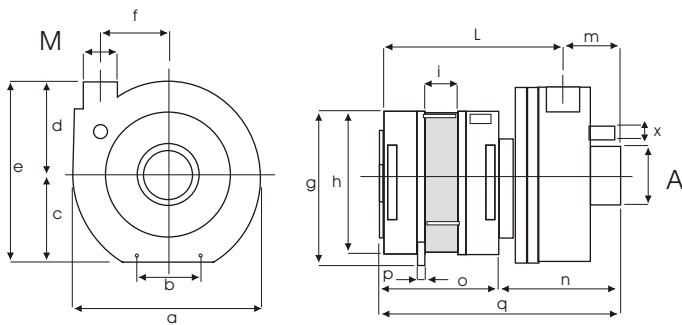

SX	A	M	DX	A	M
	L7: 45	40		L7: 45	40

mod	a	b	c	d	e	f	g	h	i	l	m	n	o	p	q	x	kg
ZF 320	170	58	70	75	150	57	149	130	40	161	44	95	110	6	205	12	5,7

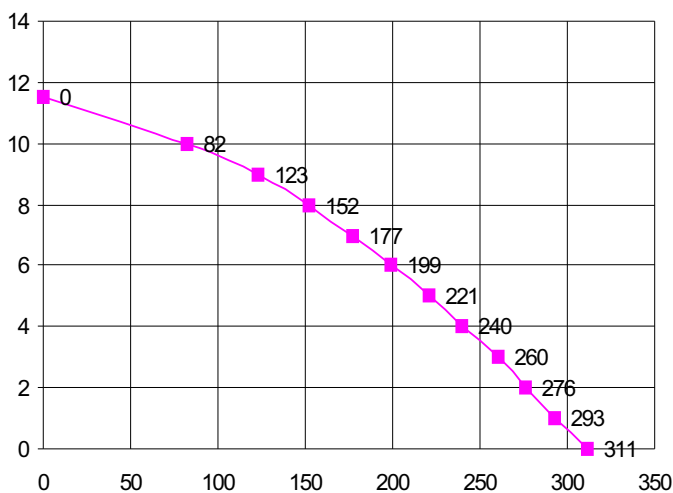

Hm	0	1	2	3	4	5	6	7	8	9	11,5
L/1'	311	293	276	260	240	221	199	177	152	123	0

Potenza motore Motor power Motor Leistung	Hp kW 0,91 0,67
Tensione/Frequenza Tension/Frequency Spannung/Frequenz	1~V/Hz 230/50
Corrente assorbita Power consumption Stromaufnahme	A 2,95
GPM RPM UPM	2800
Condensatore Capacitor Kondensator	12,5 µF
Protezione termica Thermal Overload Überlastschutz	155 °C
Classe isolamento Insulation class Isolationsklasse	F
Grado protezione Protection class Schutzklasse	IP 00
Servizio Duty Betriebsart	S1 CONTINUO CONTINUOS DAUERBETRIEB

Ci riserviamo il diritto di apportare e modificare le tecniche
We reserve the right of technical modifications
Technische Änderungen vorbehalten



ZF 320 V

kW 0.67 Hm 11.5 max
Hp 0.91 L/1' 311 max



Corpo Pompa Pump Body Pumpengehäuse	PP 30GF
Girante Aperta Open Impeller Offenes Laufrad	SPS G30
Albero Motore Motor Shaft Motorwelle	AINI 416
Tenuta Meccanica Mechanical Seal Gleitringdichtung	GRAFITE/CERAMICA CARBON/CERAMIC KOHLE/KERAMIK

Vedi Parte n.7 - ACCESSORI per STAFFAGGIO
See Part n. 7 - ACCESSORIES for SUPPORTS
Siehe Teil Nr.7 - ZUBEHÖR - für BEFESTIGUNGEN

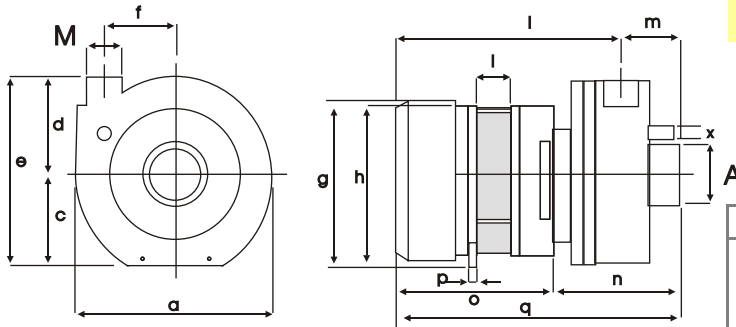

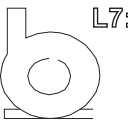
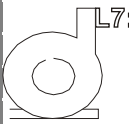
SX	A	M	DX	A	M
 L7:	45	40	 L7:	45	40

mod	a	b	c	d	e	f	g	h	i	l	m	n	o	p	q	x	kg
ZF320V	170	-	70	75	150	57	149	130	40	191	44	95	140	6	235	12	5,8

REVISIONE N.00.01/03 P141/01

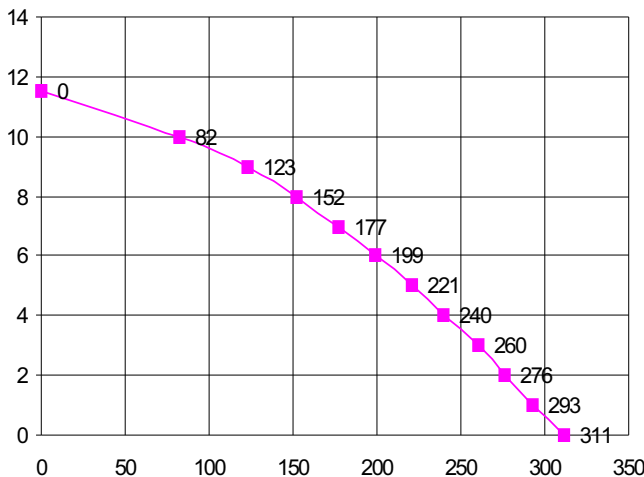

Hm	0	1	2	3	4	5	6	7	8	9	11,5
L/1'	311	293	276	260	240	221	199	177	152	123	0

Ci riserviamo il diritto di apportare modifiche tecniche
We reserve the right of technical modifications
Technische Änderungen vorbehalten

Potenza motore Motor power Motor Leistung	Hp 0,91 kW 0,67
Tensione/Frequenza Tension/Frequency Spannung/Frequenz	1~V/Hz 230/50
Corrente assorbita Power consumption Stromaufnahme	A 2,95
GPM RPM UPM	2800
Condensatore Capacitor Kondensator	12,5 µF
Protezione termica Thermal Overload Überlastschutz	155 °C
Classe isolamento Insulation class Isolationsklasse	F
Grado protezione Protection class Schutzklasse	IP 00
Servizio Duty Betriebsart	S1 CONTINUO CONTINUOS DAUERBETRIEB



ZF 340

kW 0.73 Hm 12.0 max
Hp 0.98 L/1' 340 max



Corpo Pompa
Pump Body
Pumpengehäuse **PP 30GF**

Girante Aperta
Open Impeller
Offenes Laufrad **SPS G30**

Albero Motore
Motor Shaft
Motorwelle **AISI 416**

Tenuta Meccanica
Mechanical Seal
Gleitringdichtung **GRAFITE/CERAMICA**
CARBON/CERAMIC
KOHLE/KERAMIK

Vedi Parte n.7 - ACCESSORI per STAFFAGGIO
See Part n. 7 - ACCESSORIES for SUPPORTS
Siehe Teil Nr.7 - ZUBEHÖR - für BEFESTIGUNGEN

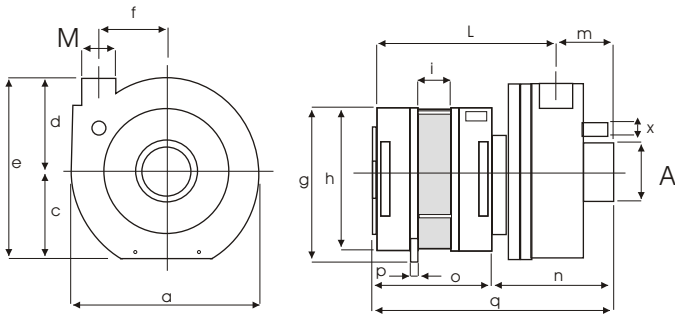

SX	A	M	DX	A	M
	L7: 45	40		L7: 45	40

mod	a	b	c	d	e	f	g	h	i	l	m	n	o	p	q	x	kg
ZF 340	170	-	70	75	150	57	149	130	45	166	44	95	115	6	210	12	5,5

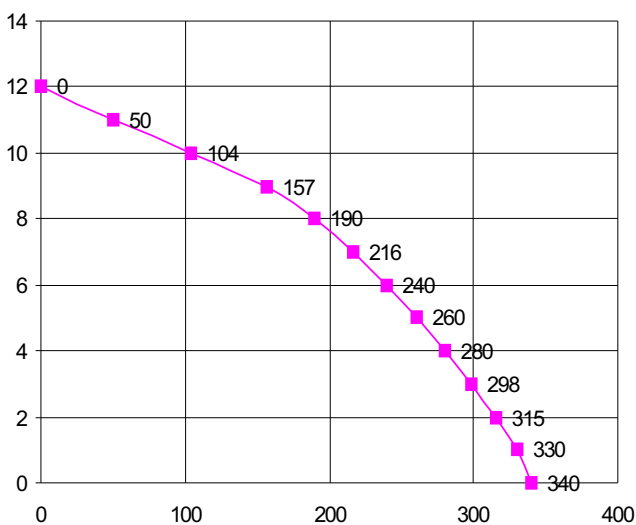

H m	0	2	4	5	6	7	8	9	12
L / 1'	340	315	280	260	240	216	190	157	0

Potenza motore **Hp kW**
Motor power **0,98 0,73**
Motor Leistung

Tensione/Frequenza **1~V/Hz**
Tension/Frequency **230/50**
Spannung/Frequenz

Corrente assorbita **A**
Power consumption **3,2**
Stromaufnahme

GPM **2800**
RPM
UPM

Condensatore **12,5 µF**
Capacitor
Kondensator

Protezione termica **155 °C**
Thermal Overload
Überlastschutz

Classe isolamento **F**
Insulation class
Isolationsklasse

Grado protezione **IP 00**
Protection class
Schutzklasse

Servizio **CONTINUO**
Duty **S1** **CONTINUOUS**
Betriebsart **DAUERBETRIEB**

Ci riserviamo il diritto di apportare modifiche tecniche

We reserve the right of technical modifications

Technische Änderungen vorbehalten

REVISIONE N.00.01/03 P142/01



ZF 340 V

kW 0.73

Hm 12.0 max

Hp 0.98

L/1' 340 max



Corpo Pompa
Pump Body
Pumpengehäuse **PP 30 GF**

Girante Aperta
Open Impeller
Offenes Laufrad **SPS G30**

Albero Motore
Motor Shaft
Motorwelle **AINI 416**

Tenuta Meccanica
Mechanical Seal
Gleitringdichtung **GRAFITE/CERAMICA
CARBON/CERAMIC
KOHLE/KERAMIK**

Vedi Parte n.7 - ACCESSORI per STAFFAGGIO
See Part n. 7 - ACCESSORIES for SUPPORTS
Siehe Teil Nr.7 - ZUBEHÖR - für BEFESTIGUNGEN

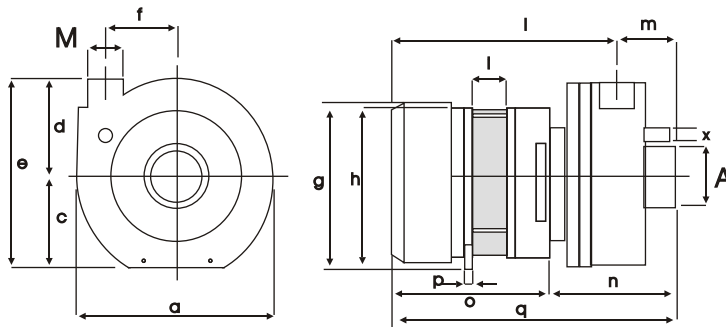

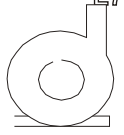
SX	A	M	DX	A	M
L7: 	45	40	L7: 	45	40

mod	a	b	c	d	e	f	g	h	i	l	m	n	o	p	q	x	kg
ZF340V	170	-	70	75	150	57	140	135	45	206	44	95	155	6	250	12	5,5

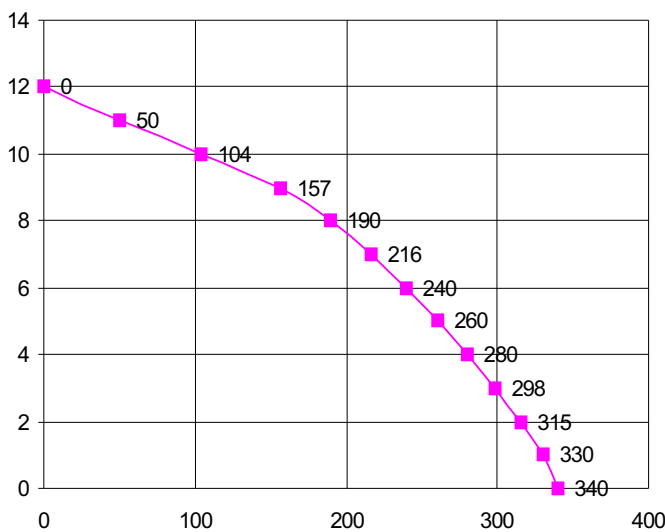

Hm	0	2	4	5	6	7	8	9	12
L / 1'	340	315	280	260	240	216	190	157	0

Ci riserviamo il diritto di apportare modifiche tecniche
We reserve the right of technical modifications
Technische Änderungen vorbehalten

Potenza motore
Motor power
Motor Leistung **Hp kW
0,98 0,73**

Tensione/Frequenza
Tension/Frequency
Spannung/Frequenz **1~V/Hz
230/50**

Corrente assorbita
Power consumption
Stromaufnahme **A
3,2**

GPM
RPM
UPM **2800**

Condensatore
Capacitor
Kondensator **16 µF**

Protezione termica
Thermal Overload
Überlastschutz **155 °C**

Classe isolamento
Insulation class
Isolationsklasse **F**

Grado protezione
Protection class
Schutzklasse **IP 00**

Servizio
Duty
Betriebsart **S1 CONTINUO
CONTINUOS
DAUERBETRIEB**

REVISIONE N.00.01/03 P142/01



ZF 400

kW 0.735 Hm 11.0 max
Hp 0.99 L/1' 368 max



Corpo Pompa
Pump Body
Pumpengehäuse **PP 30 GF**

Girante Chiusa
Closed Impeller
Geschl. Laufrad **PPO 20GF**

Albero Motore
Motor Shaft
Motorwelle **AISI 416**

Tenuta Meccanica
Mechanical Seal
Gleitringdichtung **GRAFITE/CERAMICA
CARBON/CERAMIC
KOHLE/KERAMIK**

Vedi Parte n.7 - ACCESSORI per STAFFAGGIO
See Part n. 7 - ACCESSORIES for SUPPORTS
Siehe Teil Nr.7 - ZUBEHÖR - für BEFESTIGUNGEN

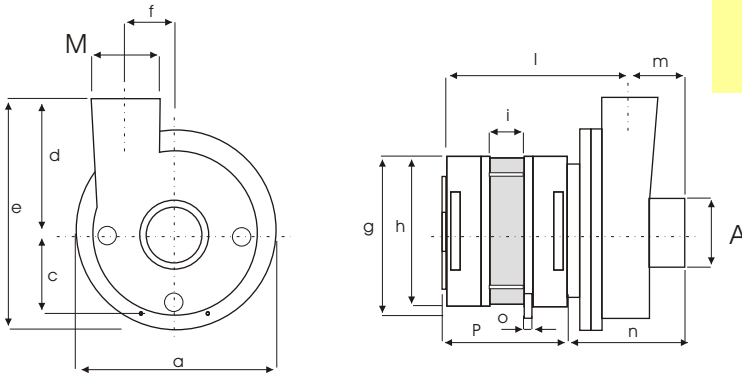

SX	A	M
L7:	45	40
L9:	50	50
L10:	60	50

mod	a	b	c	d	e	f	g	h	i	l	m	n	o	p	kg
ZF400	160	-	65	107	187	52	149	130	45	167	48	100	6	115	5,5

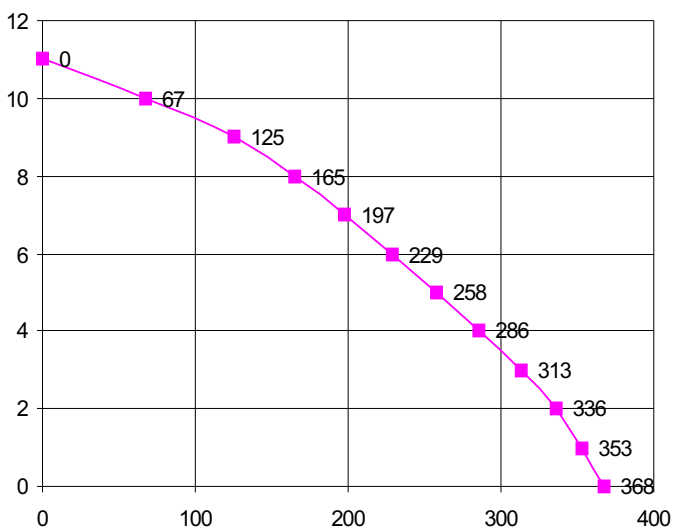

H m	0	2	3	4	5	6	7	8	9	11
L / 1'	368	336	313	286	258	229	197	165	125	0

Potenza motore
Motor power
Motor Leistung **Hp kW**
0,99 0,735

Tensione/Frequenza
Tension/Frequency
Spannung/Frequenz **1~V/Hz**
230/50

Corrente assorbita
Power consumption
Stromaufnahme **A**
3,2

GPM
RPM
UPM **2800**

Condensatore
Capacitor
Kondensator **16 µF**

Protezione termica
Thermal Overload
Überlastschutz **155 °C**

Classe isolamento
Insulation class
Isolationsklasse **F**

Grado protezione
Protection class
Schutzklasse **IP 00**

Servizio
Duty
Betriebsart **S1** **CONTINUO**
CONTINUOS
DAUERBETRIEB

Ci riserviamo il diritto di apportare modifiche tecniche

We reserve the right of technical modifications

Technische Änderungen vorbehalten

REVISIONE N.02.07/04 P:34/02



ZF40 V

kW 0.735 Hm 11.0 max
Hp 1.00 L/1' 368 max



Corpo Pompa Pump Body Pumpengehäuse	PP 30 GF
Girante Chiusa Closed Impeller Geschl. Laufrad	PPO 20GF
Albero Motore Motor Shaft Motorwelle	AISI 416
Tenuta Meccanica Mechanical Seal Gleitringdichtung	GRAFITE/CERAMICA CARBON/CERAMIC KOHLE/KERAMIK



Vedi Parte n.7 - ACCESSORI per STAFFAGGIO
See Part n. 7 - ACCESSORIES for SUPPORTS
Siehe Teil Nr.7 - ZUBEHÖR - für BEFESTIGUNGEN

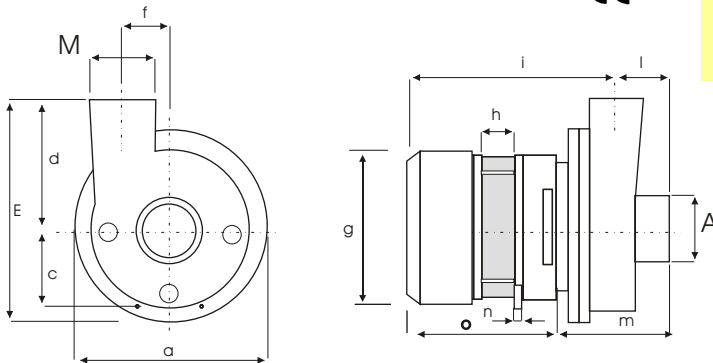

SX	A	M
L7:	45	40
L9:	50	50
L10:	60	50



mod	a	b	c	d	e	f	g	h	i	l	m	n	o	kg
ZF40 V	160	-	65	107	187	52	142	45	206	48	100	6	154	5,5

REVISIONE N.03.01/03

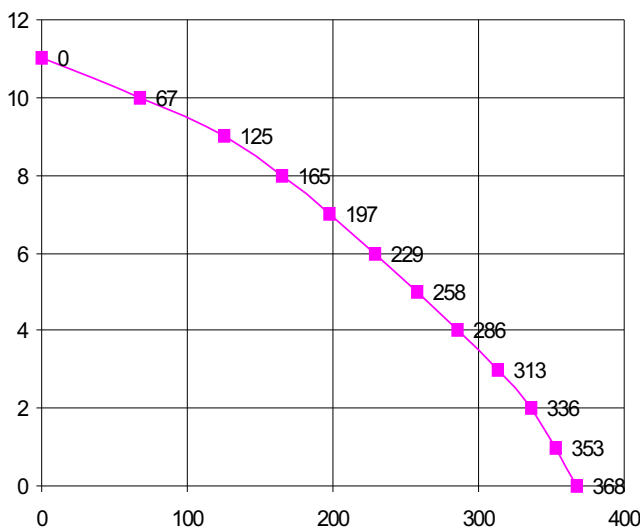

H m	0	2	3	4	5	6	7	8	9	11
L / 1'	368	336	313	286	258	229	197	165	125	0

Ci riserviamo il diritto di apportare modifiche tecniche

We reserve the right of technical modifications

Technische Änderungen vorbehalten

Potenza motore Motor power Motor Leistung	Hp kW 0,99 0,735
Tensione/Frequenza Tension/Frequency Spannung/Frequenz	1~V/Hz 230/50
Corrente assorbita Power consumption Stromaufnahme	A 3,2
GPM RPM UPM	2800
Condensatore Capacitor Kondensator	16 µF
Protezione termica Thermal Overload Überlastschutz	155 °C
Classe isolamento Insulation class Isolationsklasse	F
Grado protezione Protection class Schutzklasse	IP 00
Servizio Duty Betriebsart	S1 CONTINUO CONTINUOUS DAUERBETRIEB



ZF 522

kW 0.86
Hp 1.15

Hm 8.0 max
L/1' 520 max



Corpo Pompa
Pump Body
Pumpengehäuse **PP 30 GF**

Girante aperta
Open Impeller
Offenes Laufrad **SPS G30**

Albero Motore
Motor Shaft
Motorwelle **AISI 416**

Tenuta Meccanica
Mechanical Seal
Gleitringdichtung **GRAFITE/CERAMICA**
CARBON/CERAMIC
KOHLE/KERAMIK

Vedi Parte n.7 - ACCESSORI per STAFFAGGIO
See Part n. 7 - ACCESSORIES for SUPPORTS
Siehe Teil Nr.7 - ZUBEHÖR - für BEFESTIGUNGEN

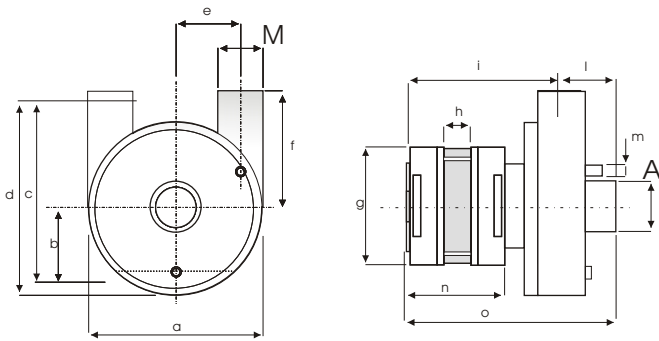

SX	A	M	DX	A	M		
	L9:	50	50		L10:	60	50
	L10:	60	50		L12:	70	60
	L11:	60	60		F4:	2"	1½"
	L12:	70	60				

mod	a	b	c	d	e	f	g	h	i	l	m	n	o	p	q	r	kg
ZF 522	204	64	178	213	73	110	149	43	169	53	12	115	225	-	-	-	6,6

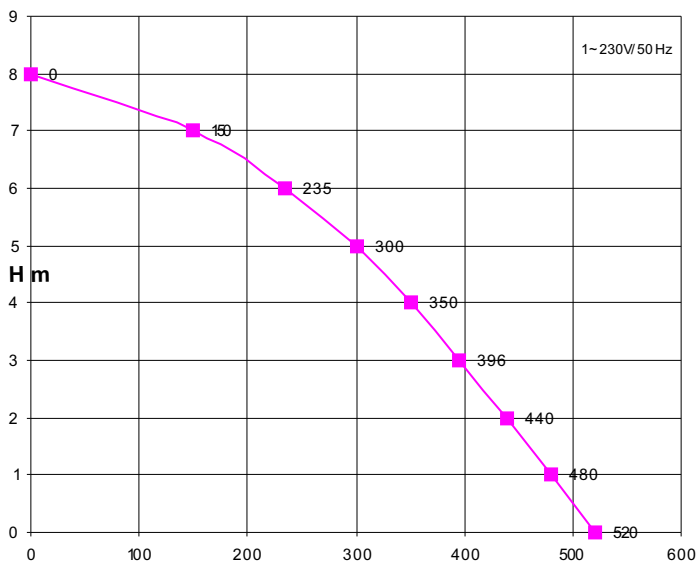

H m	0	1	2	L / Min				8	
L / 1'	520	480	440	396	350	300	235	150	0
				3	4	5	6	7	

Potenza motore **Hp kW**
Motor power **1,15 0,86**
Motor Leistung

Tensione/Frequenza **1~V/Hz**
Tension/Frequency **230/50**
Spannung/Frequenz

Corrente assorbita **A**
Power consumption **3,8**
Stromaufnahme

GPM
RPM **2800**
UPM

Condensatore
Capacitor **16 µF**
Kondensator

Protezione termica
Thermal Overload **155 °C**
Überlastschutz

Classe isolamento
Insulation class **F**
Isolationsklasse

Grado protezione
Protection class **IP 00**
Schutzklasse

Servizio **CONTINUO**
Duty **S1** **CONTINUOUS**
Betriebsart **DAUERBETRIEB**

Ci riserviamo il diritto di apportare modifiche tecniche

We reserve the right of technical modifications

Technische Änderungen vorbehalten

REVISIONE N.00.01/03 P.164/02



ZF 522 V

kW 0.86 Hm 8.0 max
Hp 1.15 L/1' 520 max



Corpo Pompa
Pump Body
Pumpengehäuse **PP 30 GF**

Girante Aperta
Open Impeller
Offenes Laufrad **SPS G30**

Albero Motore
Motor Shaft
Motorwelle **AISI 416**

Tenuta Meccanica
Mechanical Seal
Gleitringdichtung **GRAFITE/CERAMICA**
CARBON/CERAMIC
KOHLE/KERAMIK

Vedi Parte n.7 - ACCESSORI per STAFFAGGIO
See Part n. 7 - ACCESSORIES for SUPPORTS
Siehe Teil Nr.7 - ZUBEHÖR - für BEFESTIGUNGEN

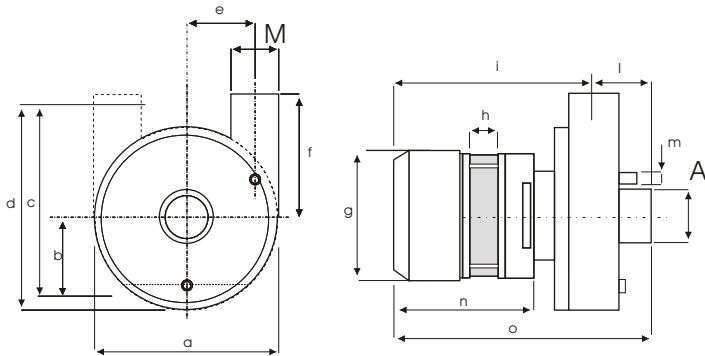

SX	A	M	DX	A	M		
	L9:	50	50		L10:	60	50
	L10:	60	50		L12:	70	60
	L11:	60	60		F4:	2"	1 1/2"
	L12:	70	60				

mod	a	b	c	d	e	f	g	h	i	l	m	n	o	p	q	r	kg
ZF522V	204	64	178	213	73	110	142	43	211	53	12	155	265	-	-	-	6,7

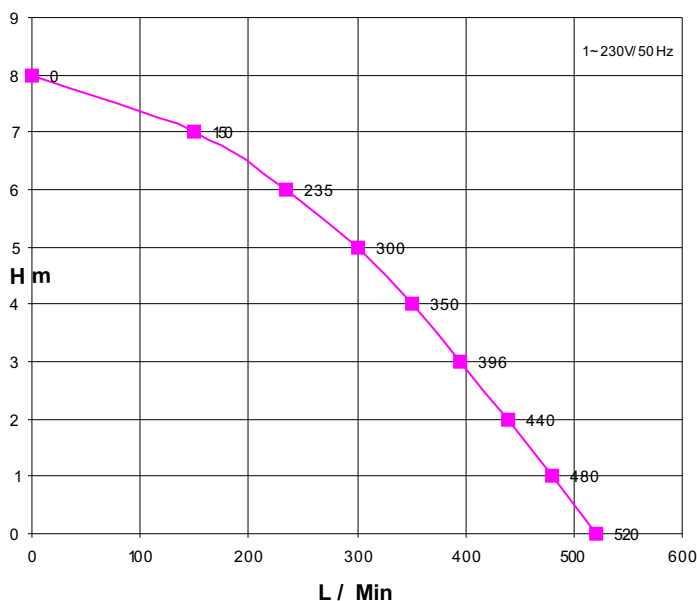

H m	0	1	2	3	4	5	6	7	8
L / 1'	520	480	440	396	350	300	235	150	0

Potenza motore
Motor power
Motor Leistung **Hp kW**
1,15 0,86

Tensione/Frequenza
Tension/Frequency
Spannung/Frequenz **1~V/Hz**
230/50

Corrente assorbita
Power consumption
Stromaufnahme **A**
3,8

GPM
RPM
UPM **2800**

Condensatore
Capacitor
Kondensator **16 µF**

Protezione termica
Thermal Overload
Überlastschutz **155 °C**

Classe isolamento
Insulation class
Isolationsklasse **F**

Grado protezione
Protection class
Schutzklasse **IP 00**

Servizio
Duty
Betriebsart **S1** **CONTINUO**
CONTINUOUS
DAUERBETRIEB

REVISIONE N.00.01/03 P164/02

Ci riserviamo il diritto di apportare modifiche tecniche

We reserve the right of technical modifications

Technische Änderungen vorbehalten



ELETTROPOMPE CON MOTORE APERTO

ELECTRIC PUMPS WITH OPEN ELECTRIC MOTOR

ELEKTROPUMPEN MIT OFFENEM MOTOR

IP 00

ALTA PRESSIONE

HOHER DRUCK

HIGH PRESSURE

4



PS 46

kW 0.27 Hm 38.0 max
Hp 0.36 L/1' 32.5 max

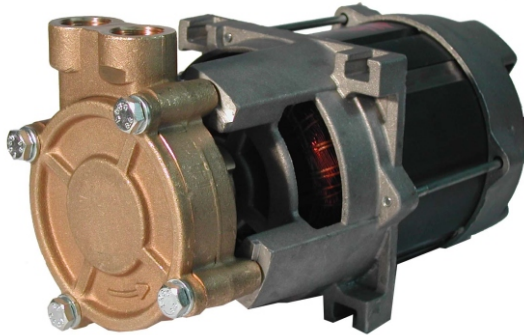

Corpo Pompa OTTONE OT 58
Pump Body BRASS 58
Pumpengehäuse MESSING MS 58

Girante a Turbina OTTONE OT 58
Turbine Impeller BRASS 58
Turbinen Laufrad MESSING MS 58

Albero Motore AISI 303
Motor Shaft
Motorwelle

Tenuta Meccanica GRAFITE/CERAMICA
Mechanical Seal CARBON/CERAMIC
Gleitringdichtung KOHLE/KERAMIK

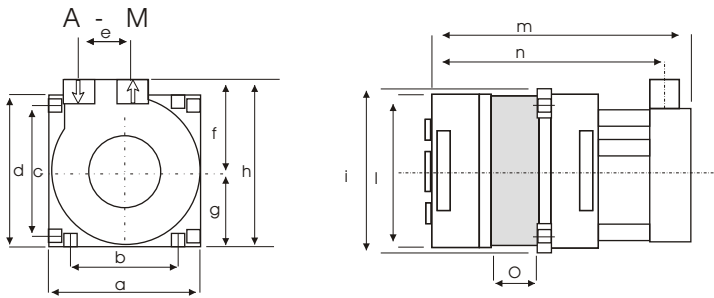

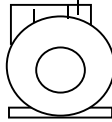
DX	A	M
F1: 	3/8"	3/8"

mod	a	b	c	d	e	f	g	h	i	l	m	n	o	p	q	r	kg
PS 46	95	63	77	95	25	57,5	49	106	102	92	188	168	54	-	-	-	4,2

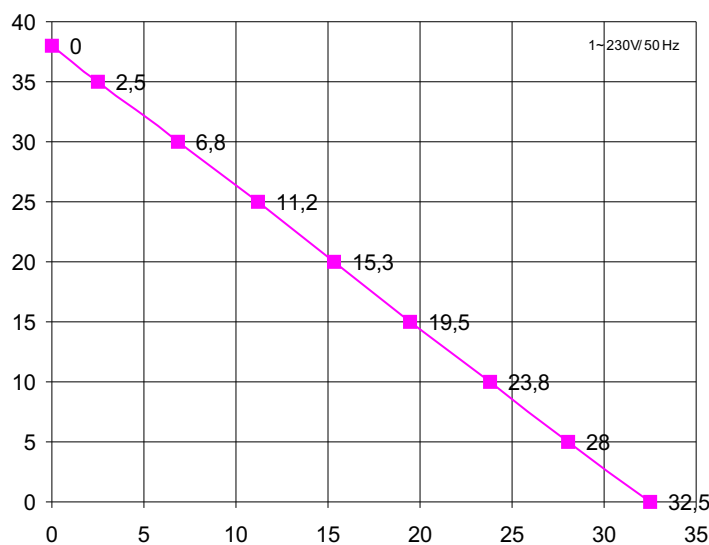

H m	0	5	10	15	20	25,0	25	30,0	38
L / 1'	32,5	28	23,8	19,5	15,3	11,2	6,8	2,5	0

Ci riserviamo il diritto di apportare modi fiche tecniche.
We reserve the right of technical modifications.
Technische Änderungen vorbehalten.

Potenza motore Hp kW
Motor power 0,36 0,27
Motor Leistung

Tensione/Frequenza 1~V/Hz
Tension/Frequency 230/50
Spannung/Frequenz

Corrente assorbita A
Power consumption 1,23
Stromaufnahme

GPM
RPM 2800
UPM

Condensatore 10 µF
Capacitor
Kondensator

Protezione termica 155 °C
Thermal Overload
Überlastschutz

Classe isolamento F
Insulation class
Isolationsklasse

Grado protezione IP 00
Protection class
Schutzklasse

Servizio S6 INTERMITTENTE
Duty INTERMITTANT
Betriebsart KURZZEITIG



ZF210AP

kW 0.60 Hm 19.5 max
Hp 0.81 L/1' 127 max



Corpo Pompa
Pump Body
Pumpengehäuse **PP30GF / PPO20GF**

Girante Chiusa
Closed Impeller
Geschl. Laufrad **PPO 20 GF**

Albero Motore
Motor Shaft
Motorwelle **AISI 416**

Tenuta Meccanica
Mechanical Seal
Gleitringdichtung **GRAFITE/CERAMICA
CARBON/CERAMIC
KOHLE/KERAMIK**

Vedi Parte n.7 - ACCESSORI per STAFFAGGIO
See Part n. 7 - ACCESSORIES for SUPPORTS
Siehe Teil Nr.7 - ZUBEHÖR - für BEFESTIGUNGEN

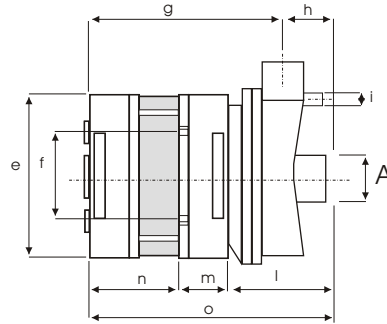
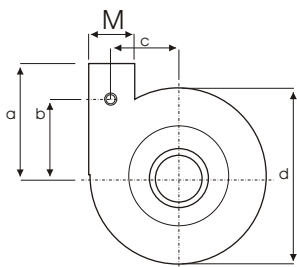

	SX	A	M
	L6:	41	31,5
	L7:	45	40
	L9:	50	50
	F3:	1"	1"

mod	a	b	c	d	e	f	g	h	i	l	m	n	o	p	q	r	kg
ZF210AP	101	60,5	60	160	149	58	144	35	13	78	33	68	179	-	-	-	5,6

Potenza motore Hp **0,81** kW **0,60**
Motor power
Motor Leistung

Tensione/Frequenza 1~V/Hz
Tension/Frequency
Spannung/Frequenz **230/50**

Corrente assorbita A
Power consumption
Stromaufnahme **2,6**

GPM
RPM **2800**
UPM

Condensatore
Capacitor
Kondensator **12,5 µF**

Protezione termica
Thermal Overload
Überlastschutz **155 °C**

Classe isolamento
Insulation class
Isolationsklasse **F**

Grado protezione
Protection class
Schutzklasse **IP 00**

Servizio **S1** **CONTINUO**
Duty **CONTINUOUS**
Betriebsart **DAUERBETRIEB**

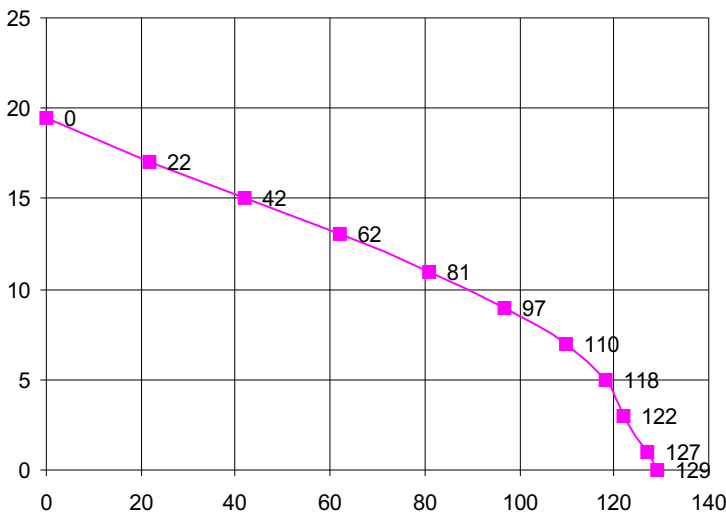

Hm	0	1	3	5	7	9	11	13	15	17	19,5
L/1'	129	127	122	118	110	97	81	62	42	22	0

Ci riserviamo il diritto di apportare modifiche tecniche

We reserve the right of technical modifications

Technische Änderungen vorbehalten

REVISIONE N.03.01/03



ZF 110

kW 0.40 Hm 9.0 max
Hp 0.54 L/1' 132 max



Corpo Pompa
Pump Body
Pumpengehäuse PP30GF / PPO20GF

Girante Aperta
Open Impeller
Offenes Laufrad SPS G30

Albero Motore
Motor Shaft
Motorwelle AISI 416

Tenuta Meccanica
Mechanical Seal
Gleitringdichtung GRAFITE/CERAMICA
CARBON/CERAMIC
KOHLE/KERAMIK

Vedi Parte n.7 - ACCESSORI per STAFFAGGIO
See Part n. 7 - ACCESSORIES for SUPPORTS
Siehe Teil Nr.7 - ZUBEHÖR - für BEFESTIGUNGEN

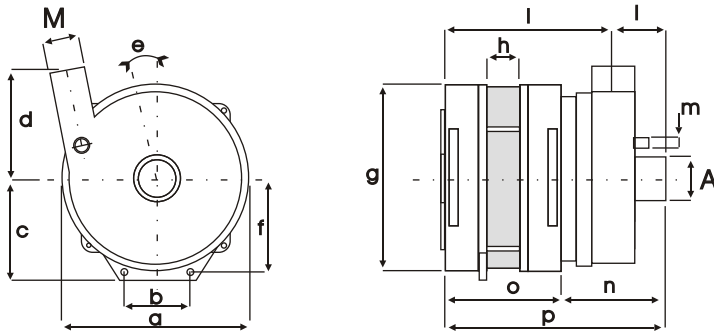

SX	A	M
	L4: 30	30
	F2: 1"	3/4"

mod	a	b	c	d	e	f	g	h	i	l	m	n	o	p	kg	
ZF 110	130	58	70	70	10°	64	149	18	119	39	12	71	87	159	-	3,7

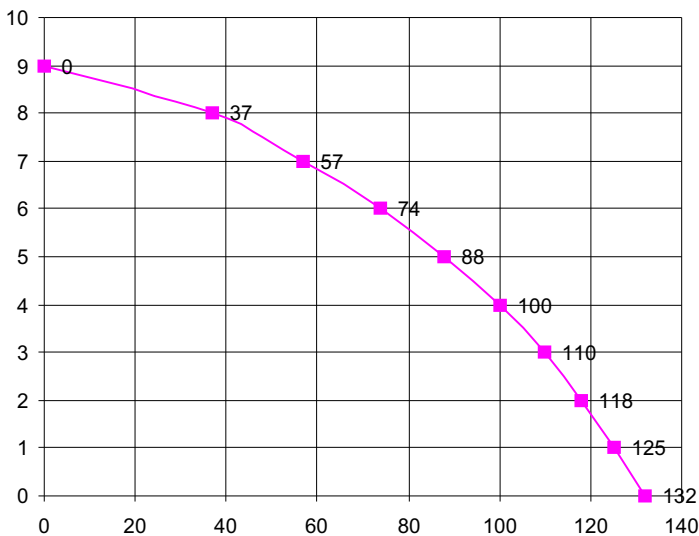

Hm	0	1	2	3	4	5	6	7	8	9
L / 1'	132	125	118	110	100	88	74	57	37	0

Ci riserviamo il diritto di apportare modifiche tecniche
We reserve the right of technical modifications
Technische Änderungen vorbehalten

Potenza motore
Motor power
Motor Leistung Hp 0,54 kW 0,4

Tensione/Frequenza
Tension/Frequency
Spannung/Frequenz 1~V/Hz 230/50

Corrente assorbita
Power consumption
Stromaufnahme A 2,3

GPM
RPM
UPM 2800

Condensatore
Capacitor
Kondensator 8 µF

Protezione termica
Thermal Overload
Überlastschutz 155 °C

Classe isolamento
Insulation class
Isolationsklasse F

Grado protezione
Protection class
Schutzklasse IP 00

Servizio
Duty
Betriebsart S1 CONTINUO
CONTINUOUS
DAUERBETRIEB

REVISIONE N.03.01/03



PPL 46

kW 0.28 Hm 34 max
Hp 0.38 L/1' 24 max

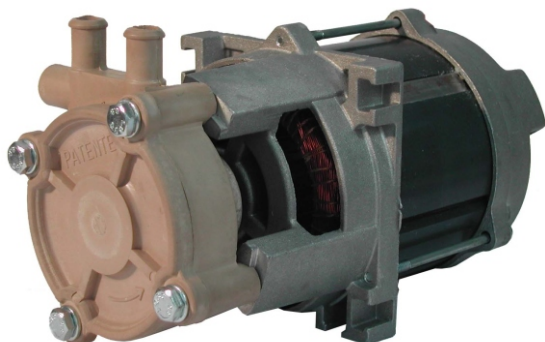

Corpo Pompa Pump Body Pumpengehäuse	RYTON
Girante a Turbina Turbine Impeller Turbinen Laufrad	PPO 20GF
Albero motore Motor Shaft Motorwelle	AISI 416
Tenuta meccanica Mechanical Seal Gleitringdichtung	GRAFITE/CERAMICA CARBON/CERAMIC KOHLE/KERAMIK

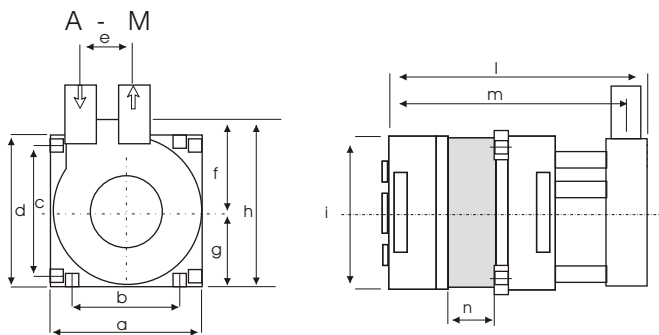

DX	A	M
	Ø11,5	Ø11,5

REVISIONE N.00.01/03 P94/02

mod	a	b	c	d	e	f	g	h	i	l	m	n	o	p	q	r	kg
PPL 46	95	63	75	95	30	62	49	111	102	188	170	54	-	-	-	-	3,5

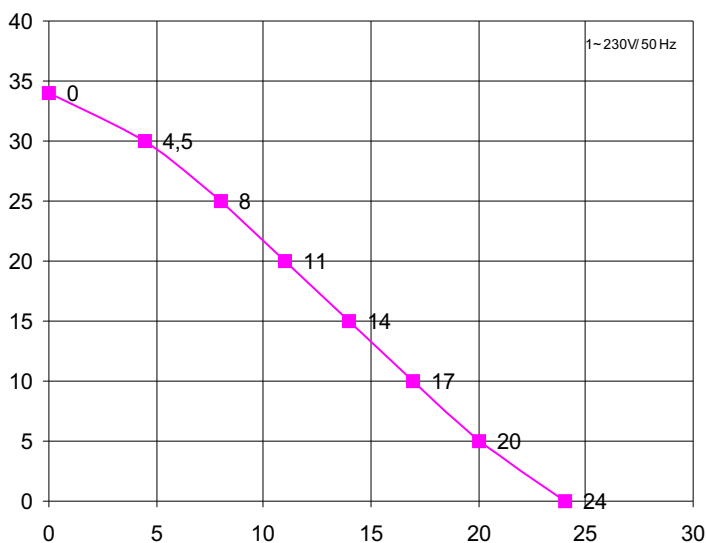

H m	0	5	10	15	20	25	30	34,0
L / 1'	24	20	17,0	14,0	11,0	8,0	4,5	0,0

Ci riserviamo il diritto di apportare modi fiche tecniche.
We reserve the right of technical modifications.
Technische Änderungen vorbehalten.

Potenza motore Motor power Motor Leistung	Hp	kW
	0,38	0,28
Tensione/Frequenza Tension/Frequency Spannung/Frequenz	1~V/Hz	230/50
Corrente assorbita Power consumption Stromaufnahme	A	1,27
GPM RPM UPM	2800	
Condensatore Capacitor Kondensator	10 µF	
Protezione termica Thermal Overload Überlastschutz	155 °C	
Classe isolamento Insulation class Isolationsklasse	F	
Grado protezione Protection class Schutzklasse	IP 00	
Servizio Duty Betriebsart	S6	INTERMITTENTE INTERMITTANT KURZZEITIG